

TOOL and REAMER ATTACHMENT

FOR 9", LT. 10, 10", 13", 14½", 16" & 16/24"

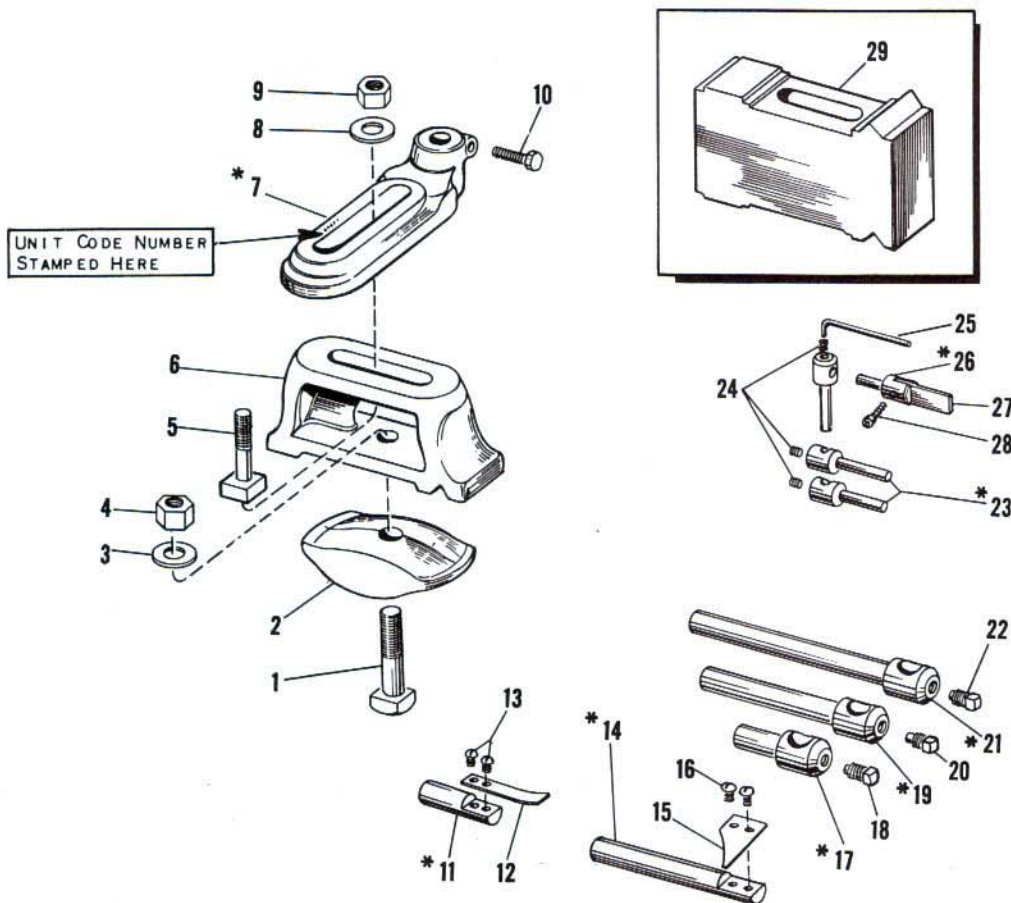

*AVAILABLE ONLY AS SUB-ASSEMBLY. PARTS INCLUDED ARE INDICATED BY THE ITEM NUMBERS APPEARING IN PARENTHESIS AFTER PART NAME.

SERIAL NUMBER OF LATHE AND UNIT CODE NUMBER "MUST" ACCOMPANY ORDER.

ITEM NO.	PART NAME	9" & LIGHT 10		10" (11/16" & 1" COL.)		13"	
		PART NO.		PART NO.		PART NO.	
1	BOLT	143 X 210		143 X 312		143 X 410	
2	CLAMP	PT127NK4		PT127R1		PT127T1	
3	WASHER	161 X 25		161 X 30		161 X 36	
4	NUT	136 X 29		136 X 30		136 X 35	
5	BOLT (8-9)	NOT USED		NOT USED		PT517T1	
6	SPRING STOP PLATE	NOT USED		NOT USED		PT1225T1	
7	SPRING STOP SOCKET (10)	*AS1226NR1		*AS1226NR1		*AS1226T1	
8	WASHER	NOT USED		NOT USED		161 X 65	
9	NUT	NOT USED		NOT USED		136 X 31	
10	CAP SCREW	112 X 16		112 X 16		112 X 116	
11	SPRING STOP SHANK (12-13)	*AS1227NH1		*AS1227NH1		*AS1227NH1	
12	SPRING STOP - VERTICAL	PT1229NH1		PT1229NH1		PT1229NH1	
13	SCREW	101 X 107		101 X 107		101 X 107	
14	SPRING STOP BAR (15-16)	*AS1234NH1		*AS1234NH1		*AS1234NH1	
15	SPRING STOP - HORIZONTAL	PT1235NH1		PT1235NH1		PT1235NH1	
16	SCREW	101 X 306		101 X 306		101 X 306	
17	SWIVEL BAR - SHORT (18)	*AS1231NH1		*AS1231NH1		*AS1231NH1	
18	SET SCREW	119 X 108		119 X 108		119 X 108	
19	SWIVEL BAR - MEDIUM (20)	*AS1232NH1		*AS1232NH1		*AS1232NH1	
20	SET SCREW	119 X 108		119 X 108		119 X 108	
21	SWIVEL BAR - LONG (22)	*AS1233NH1		*AS1233NH1		*AS1233NH1	
22	SET SCREW	119 X 108		119 X 108		119 X 108	
23	SWIVEL BAR (24)	*AS1594NH1		*AS1594NH1		*AS1594NH1	
24	SET SCREW	120 X 4		120 X 4		120 X 4	
25	HEX WRENCH	173 X 6		173 X 6		173 X 6	
26	SPRING STOP SHANK (27-28)	*AS1595NH1		*AS1595NH1		*AS1595NH1	
27	SPRING STOP	PT1596NH1		PT1596NH1		PT1596NH1	
28	SCREW	103 X 210		103 X 210		103 X 210	
29	RAISING BLOCK	-----		-----		-----	

ITEM NO.	PART NAME	14 1/2"		16"		16/24"	
		PART NO.		PART NO.		PART NO.	
1	BOLT	143 X 514		143 X 514		143 X 534	
2	CLAMP	PT127F1		PT127H1		PT127H1	
3	WASHER	161 X 41		161 X 41		161 X 41	
4	NUT	136 X 39		136 X 39		136 X 39	
5	BOLT (8-9)	PT517FH1		PT517FH1		PT517FH1	
6	SPRING STOP PLATE	PT1225F1		PT1225H1		PT1225H1	
7	SPRING STOP SOCKET (10)	*AS1226FH1		*AS1226FH1		*AS1226FH1	
8	WASHER	161 X 65		161 X 65		161 X 65	
9	NUT	136 X 31		136 X 31		136 X 31	
10	CAP SCREW	112 X 216		112 X 216		112 X 216	
11	SPRING STOP SHANK (12-13)	*AS1227NH1		*AS1227NH1		*AS1227NH1	
12	SPRING STOP - VERTICAL	PT1229NH1		PT1229NH1		PT1229NH1	
13	SCREW	101 X 107		101 X 107		101 X 107	
14	SPRING STOP BAR (15-16)	*AS1234NH1		*AS1234NH1		*AS1234NH1	
15	SPRING STOP - HORIZONTAL	PT1235NH1		PT1235NH1		PT1235NH1	
16	SCREW	101 X 306		101 X 306		101 X 306	
17	SWIVEL BAR - SHORT (18)	*AS1231NH1		*AS1231NH1		*AS1231NH1	
18	SET SCREW	119 X 108		119 X 108		119 X 108	
19	SWIVEL BAR - MEDIUM (20)	*AS1232NH1		*AS1232NH1		*AS1232NH1	
20	SET SCREW	119 X 108		119 X 108		119 X 108	
21	SWIVEL BAR - LONG (22)	*AS1233NH1		*AS1233NH1		*AS1233NH1	
22	SET SCREW	119 X 108		119 X 108		119 X 108	
23	SWIVEL BAR (24)	*AS1594NH1		*AS1594NH1		*AS1594NH1	
24	SET SCREW	120 X 4		120 X 4		120 X 4	
25	HEX WRENCH	173 X 6		173 X 6		173 X 6	
26	SPRING STOP SHANK (27-28)	*AS1595NH1		*AS1595NH1		*AS1595NH1	
27	SPRING STOP	PT1596NH1		PT1596NH1		PT1596NH1	
28	SCREW	103 X 210		103 X 210		103 X 210	
29	RAISING BLOCK	-----		-----		PT2003H1	