

9" & 10-K GEAR BOX
Model A

GEAR BOX PARTS

ITEM NO.	PART NO.	PART NAME
1	140 x 29	Nut
2	161 x 73	Washer
3	164 x 86	Key
4	*AS603NK1	Shaft (1,2,3,5,12,13)
5	164 x 17	Key
6	PT627NK1	Order Item 8
7	160 x 17	Straight Pin
8	*AS625NK1	Comp. Pinion (6,7)
9	PT626NK1	Order Item 11
10	160 x 16	Straight Pin
11	*AS619NK1	Comp. Pinion (9, 10)
12	PT604NK1	Collar
13	168 x 108	Taper Pin
14	*AS1541NK3	Index Plt. (15)
15	132 x 1	Screw
16	155 x 38	Oiler
17	256 x 3	Felt Wick
18	PT606NK2	Bushing
19	160 x 31	Straight Pin
20	AS600NK1	Gear Box
21	PT628NK1	Lead Scr. Gear
22	PT601NK2	Bushing
23	111 x 6	Screw
24	160 x 19	Pin
25	PT607NK1	Guide Bar
26	PT1807	Pin
27	160 x 27	Pin
28	*AS88R2	Knob (27,38,39)
29	PT610NR1	Bushing
30	*AS605NK1	Gear (33)
31	160 x 42	Pin
32R	*AS400NK2	R. H. Tumbler (27, 28,29,30,31,33,38,39)
32L	*AS401NK1	L. H. Tumbler (27, 28,29,30,31,33,38,39)
33	PT384NK1	Bearing
34	160 x 252	Shaft
35	PT620NK1	Shaft
36	256 x 1	Felt Wick
37	PT621NK1	Gear
38	162 x 50	Spring
39	PT608NR1	Plunger
40	PT624NK1	Gear
41	PT626NK1	Order Item 43
42	160 x 16	Pin
43	*AS623NK1	Pinion Gear (40,42)
44	PT626NK1	Order Item 45
45	*AS622NK1	Pinion Gear (42,44)
46	PT615K16NK1	Cone Gear 16T
47	168 x 310	Taper Pin
48	PT615K18NK1	Cone Gear 18T
49	PT615K20NK1	Cone Gear 20T
50	PT615K22NK1	Cone Gear 22T
51	PT615K23NK1	Cone Gear 23T
52	PT615K24NK1	Cone Gear 24T
53	PT615K26NK1	Cone Gear 26T
54	PT615K28NK1	Cone Gear 28T
55	160 x 251	Pin
56	*AS614NK1	Shaft (55,57,58)
57	256 x 1	Wick
58	164 x 22	Key

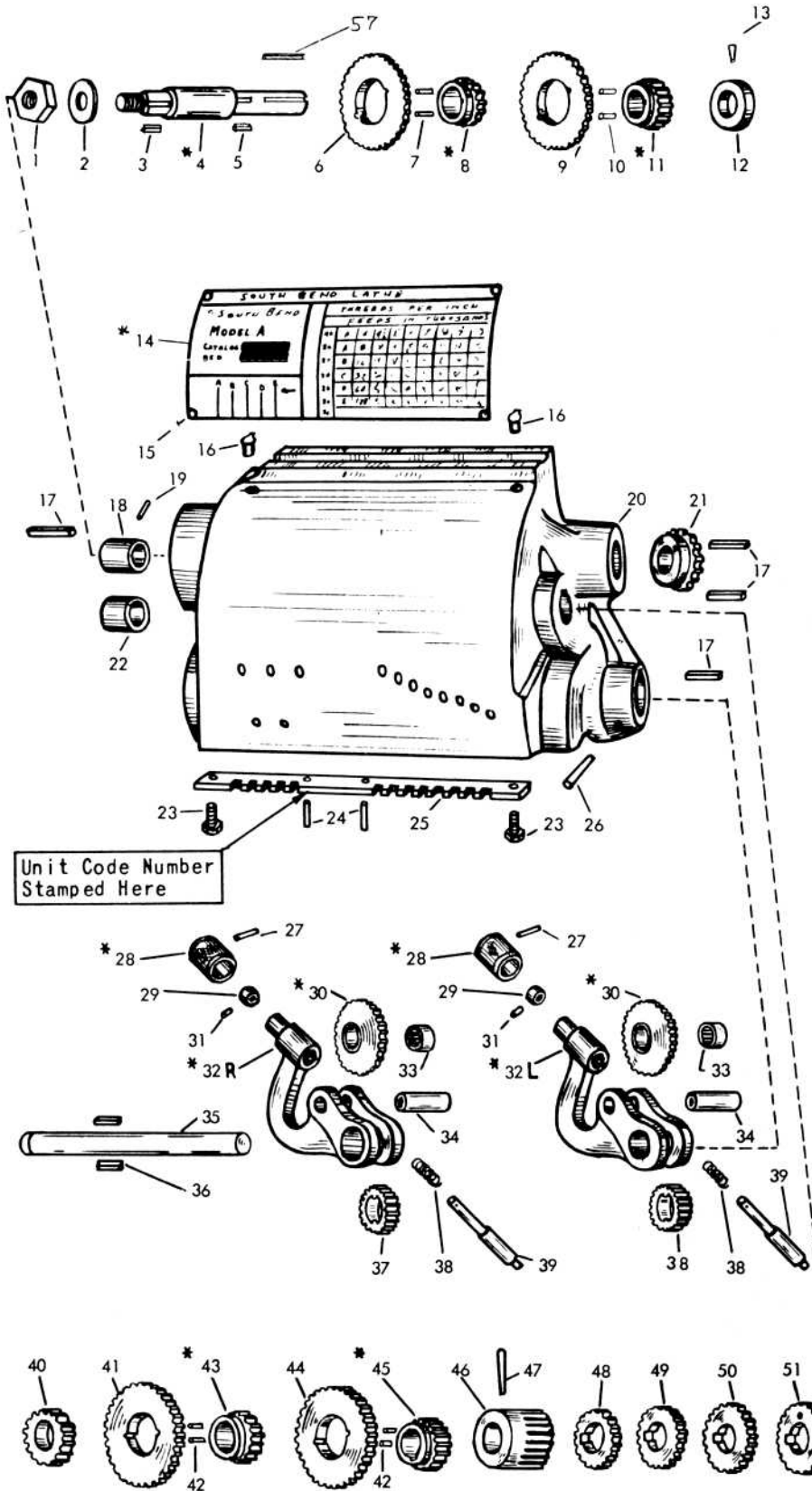

Continued on reverse side
Prices Net F. O. B. South Bend, Ind.
(Subject to change without notice)

*AVAILABLE ONLY AS SUB-ASSEMBLY. PARTS INCLUDED ARE INDICATED BY THE ITEM NUMBERS APPEARING IN PARENTHESIS AFTER PART NAME.

SERIAL NUMBER OF LATHE AND UNIT CODE NUMBER 'MUST' ACCOMPANY ORDER

Serial Number of Lathe and Unit Code Number MUST Accompany Order

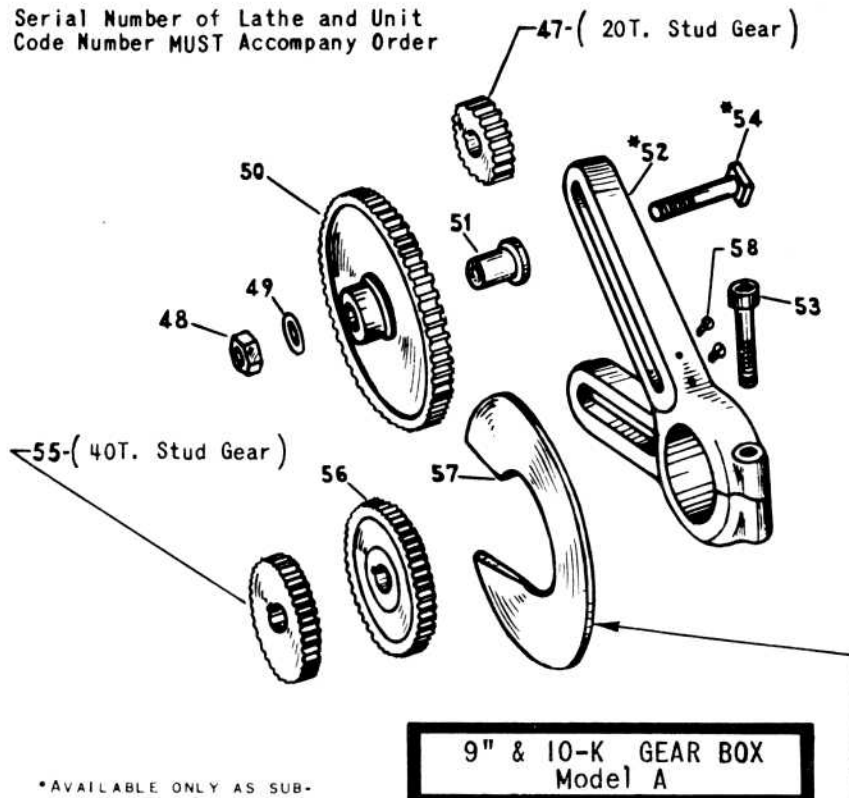

9" & 10-K GEAR BOX Model A

*AVAILABLE ONLY AS SUB-ASSEMBLY. PARTS INCLUDED ARE INDICATED BY THE ITEM NUMBERS APPEARING IN PARENTHESIS AFTER PART NAME.

NOTE: This Guard, With Screws, Item No. 57A Also Used On Models B And C.

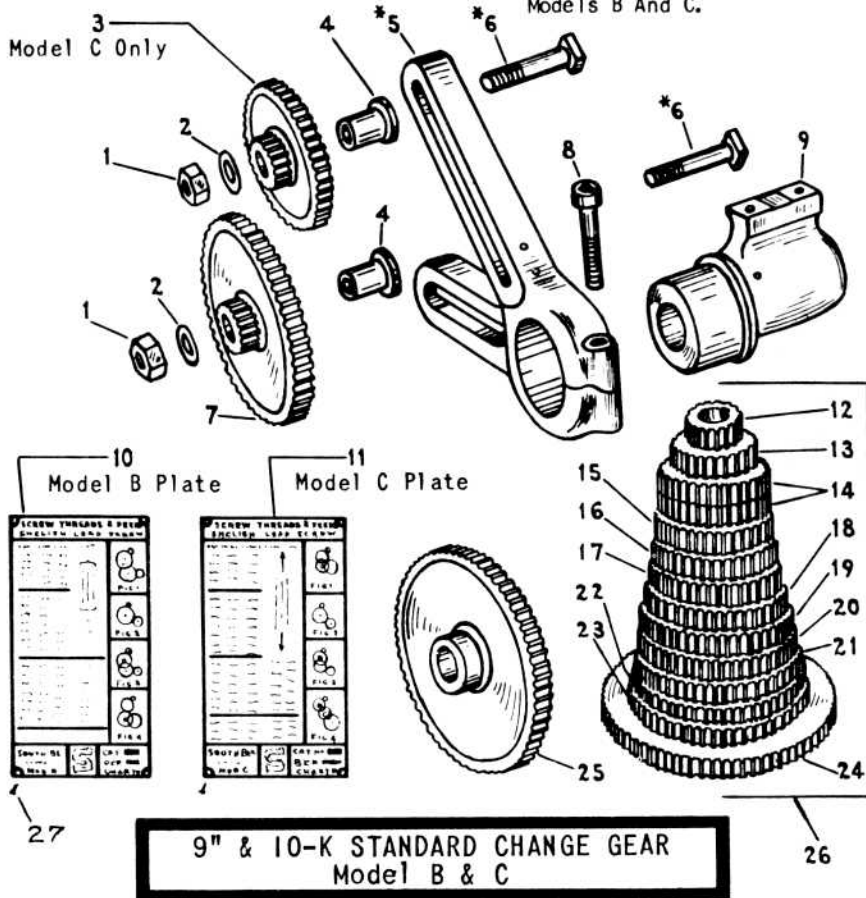

9" & 10-K STANDARD CHANGE GEAR Model B & C

GEAR BOX PARTS

ITEM NO.	PART NO.	PART NAME
47	PT32K20NKI	GEAR, 20 T.
48	140X29	NUT
49	161X21	WASHER
50	PT33NKI	IDLER GEAR
51	PT38NKI	BUSHING
52	*AS31NKI	BRACKET (53)
53	114x228	SCREW
54	*A9247NKI	BOLT (48-49)
55	PT32K40NKI	GEAR, 40 T.
56	PT32K56NKI	GEAR, 56 T.
57	PT389NK3	GUARD
58	PT1150NR1	SCREW

STANDARD CHANGE GEAR PARTS

ITEM NO.	PART NO.	PART NAME
1	140X29	NUT
2	161X21	WASHER
3	AS336NKI	COMP. GEAR, 18/54T
4	PT38NKI	BUSHING
5	*AS31NKI	BRACKET (8)
6	*AS247NKI	BOLT (1-2)
7	AS36NKI	COMP. GEAR, 18/72T
8	114X228	SCREW
9	PT4NKI	FRONT BRACKET
10	AS1525NK3	INDEX PLATE
11	AS1527JNR2	INDEX PLATE
12	PT32K16NKI	CHANGE GEAR, 16T
13	PT32K24NKI	CHANGE GEAR, 24T
14	PT32K32NKI	CHANGE GEAR, 32T
15	PT32K36NKI	CHANGE GEAR, 36T
16	PT32K40NKI	CHANGE GEAR, 40T
17	PT32K44NKI	CHANGE GEAR, 44T
18	PT32K46NKI	CHANGE GEAR, 46T
19	PT32K48NKI	CHANGE GEAR, 48T
20	PT32K52NKI	CHANGE GEAR, 52T
21	PT32K54NKI	CHANGE GEAR, 54T
22	PT32K56NKI	CHANGE GEAR, 56T
23	PT32K60NKI	CHANGE GEAR, 60T
24	PT32K80NKI	CHANGE GEAR, 80T
25	PT33NKI	
26	*AS32NKI	CHANGE GEARS
27	132X1	SCREW