

BELTS AND LUBRICATION

A TEXALON FLAT BELTS. A combination of textile and extruded nylon form a strong flexible belt recommended for use with South Bend Lathes. Able to withstand continual flexing without significant stretch and loss of efficiency. Texalon belts are skived on both ends and cement for joining skived ends is included with each belt. Shipping weight each approx. 1/2 lb.

Type of Drive	Cat. No.	Type of Drive	Cat. No.
9" HMD	CE3750N	13" UMD 3-Step	CE3753T
10-K HMD	CE3750K	14 1/2" UMD 4-Step	CE3752F
9" UMD	CE3752N	14 1/2" UMD 3-Step	CE3753F
10-K UMD	CE3752K	16" UMD 4-Step	CE3752H
10" UMD Bench	CE3753R	16" UMD 3-Step	CE3753H
10" UMD Floor	CE3752R	16-24" UMD 4-Step	CE3752V
13" UMD 4-Step	CE3752T	16-24" UMD 3-Step	CE3753V
		16" Turret	CE3753H

B TEXALON BELT CEMENT for bonding skived ends of Texalon Belts.
CE1887. Texalon Belt Cement 1/4 oz. bottle

CE2323N. Oak tan single ply flat leather belt without cord reinforcing for 9" Horizontal Motor Drive only. Has square ends and lace for joining. Price f.o.b. factory

C BELT SPLICING CLAMPS. For gluing skived ends of cone pulley belts or other flat leather belts. Made of heavy steel plate with guide for aligning edges of belt ends.

Catalog Number	Maximum Size of Belt			Ship. Wt.
	Width	Thickness	Skive Length	
CE1898	1 3/4"	1/2"	6 3/8"	4 lbs.
CE1899	3"	1/2"	6 3/8"	5 lbs.

D LUBRICATING OIL. Nothing is more important to the satisfactory operation and life of fine machinery than correct lubrication. The lubricating oils listed below have been thoroughly tested in our research laboratory and are highly recommended. It is essential that the correct type of oil be used for the lathe spindle, lathe apron and shaper oil reservoirs and general lubrication. A supply of each kind of oil should be kept on hand and used as needed. The Saybolt viscosity of the various oils is indicated in seconds at 100°F.

Cat. No.	Viscosity	Quantity	Ship. Wt.
General Lubricating Oil (See Oil Chart for Individual Machine)			
CE1603	240-500	1 quart	3 lbs.
CE1906	240-500	12 quarts	31 lbs.
CE2019	240-500	Gal. can	11 lbs.
Oil for Spindle Bearings of South Bend Lathes (For other components see Oil Chart for Individual Machine)			
CE1600	100	1 quart	3 lbs.
CE1905	100	12 quarts	31 lbs.
CE2017	100	Gal. can	11 lbs.
Oil for Lathes and Shapers (See Oil Chart for Individual Machine)			
CE1602	150-240	1 quart	3 lbs.
CE1904	150-240	12 quarts	31 lbs.
CE2018	150-240	Gal. can	11 lbs.

LEATHER V-BELTS FOR CONE PULLEYS

Lathe cone pulley V-belts can be replaced without disassembling the lathe headstock or drive unit by using these cord reinforced leather V-belts. Belts are skived for gluing and belt splicing cement is included.



Cat. No.	Size Lathe	Drive	Ship. Wt.
CE5L61L	9"	U.M.D.	1 lb.
CE5L62L	10-K	U.M.D.	1 lb.
CE5L54L	9"	H.M.D.	1 lb.
CE5L51L	10-K	H.M.D.	1 lb.

NOT PERMISSABLE TO SHIP BY ANY OF THE AIR SERVICES

Rubber V-Belts

Rubber V-Belts for use with South Bend Lathes and other power driven machinery. Specify catalog number, maximum width, and outside circumference when ordering. Ship. wt. each, approximately 1/2 lb.

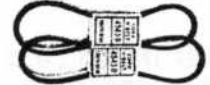

Catalog Number	Outside Length	Catalog Number	Outside Length
V-Belts with 3/8" Top Width			
CE3L210	21"	CE3L240	24"
CE3L220	22"	CE3L260	26"
CE3L230	23"	CE3L270	27"
V-Belts with 1/2" Top Width			
CE4L280	28"	CE4L480	48"
CE4L290	29"	CE4L490	49"
CE4L300	30"	CE4L530	53"
CE4L310	31"	CE4L540	54"
CE4L320	32"	CE4L580	58"
CE4L440	44"	CE4L600	60"
CE4L450	45"	CE4L640	64"
CE4L460	46"	CE4L700	70"
CE4L470	47"	CE4L800	80"
V-Belts with 5/8" Top Width			
CE5L380	38"	CE5L460	46"
CE5L400	40"	CE5L470	47"
CE5L410	41"	CE5L490	49"
CE5L420	42"	CE5L500	50"
CE5L430	43"	CE5L510	51"
CE5L440	44"	CE5L520	52"
CE5L450	45"	CE5L550	55"

Chuck Wrenches

Catalog Number	Size Square	Shipping Weight
CE2748	.277"	2 lbs
CE2742	.297"	1 lb.
CE2743	.375"	2 lbs.
CE2749	.400"	2 lbs.
CE2744	.420"	2 lbs.
CE2746	.570"	2 lbs.

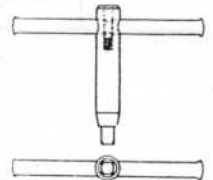

Sizes of Wrenches Required for Various Sizes of Chucks

Cat. No. of Chuck	Size of Chuck	Type of Chuck	Size Square	Cat. No. of Required Wrench
CL4006NK	6"	Independent	.297"	CE2742
CL4206NK	6"	Independent	.297"	CE2742
CL4006R	6"	Independent	.297"	CE2742
CL4206R	6"	Independent	.297"	CE2742
CL4207R	7 1/2"	Independent	.420"	CE2744
CL4006L	6"	Independent	.297"	CE2742
CL4206LO	6"	Independent	.297"	CE2742
CL4207LO	7 1/2"	Independent	.420"	CE2744
CL4209Q	9"	Independent	.420"	CE2744
CL4207MH	7 1/2"	Independent	.420"	CE2744
CL4209MH	9"	Independent	.420"	CE2744
CL4210MH	10"	Independent	.420"	CE2744
CL4212H	12"	Independent	.420"	CE2744
CL3005NK	5"	Universal	.277"	CE2748
CL3505NK	5"	Universal	.375"	CE2743
CL3506NK	6"	Universal	.400"	CE2749
CL3005R	5"	Universal	.277"	CE2748
CL3505R	5"	Universal	.375"	CE2743
CL3506R	6"	Universal	.400"	CE2749
CL3005L	5"	Universal	.277"	CE2748
CL3505LO	5"	Universal	.375"	CE2743
CL3506LO	6"	Universal	.400"	CE2749
CL3507Q	7 1/2"	Universal	.400"	CE2749
CL3505MH	5"	Universal	.375"	CE2743
CL3506MH	6"	Universal	.400"	CE2749
CL3507MH	7 1/2"	Universal	.400"	CE2749
CL3509MH	9"	Universal	.570"	CE2746

MOTOR PULLEYS

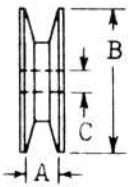

STYLE 1

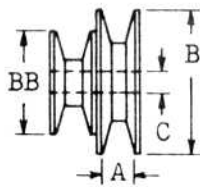

STYLE 2A

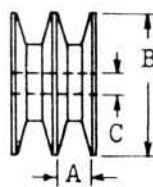

STYLE 2

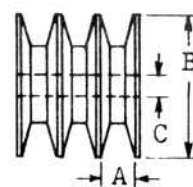

STYLE 3

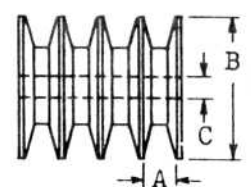

STYLE 4

Part No.	A	B	BB	C
S T Y L E 1				
PT2101NR1	.635	2- 3/32		5/8
PT2106NR1	.635	2-15/32		5/8
PT2111NR1	.635	3		5/8
PT2116NR1	.635	3-45/64		5/8
S T Y L E 2A				
PT2131NR1	.635	3.408	2.093	5/8
PT2181NR1	.635	3.570	2.093	5/8
PT2183NR1	.635	3.570	2.093	7/8
PT2131K1	.635	3.956	2.237	5/8
PT2136K1	.635	4- 3/16	2-43/64	5/8
PT2185NK1	.635	4- 3/16	2-23/32	5/8
PT2187NK1	.635	4- 3/16	2-23/32	7/8
PT2136NR1	.635	4- 3/16	2.822	5/8
PT2138NR1	.635	4- 3/16	2.822	7/8
PT2127R1	.635	4-19/32	3- 5/32	5/8
PT2129R1	.635	4-19/32	3- 5/32	7/8
PT2156R1	.635	5- 5/16	2- 3/32	5/8
PT2158R1	.635	5- 5/16	2- 3/32	7/8

Part No.	A	B	C
S T Y L E 2			
PT2101T1	.490	2-17/32	7/8
PT2103T1	.490	2-17/32	1-1/8
PT2106T1	.490	2-63/64	7/8
PT2108T1	.490	2-63/64	1-1/8
PT2127T1	.490	4-21/64	7/8
PT2129T1	.490	4-21/64	1-1/8
S T Y L E 3			
PT2101F1	.490	2-17/32	7/8
PT2106F1	.490	2-63/64	7/8
S T Y L E 4			
PT2101H1	.490	2- 1/8	7/8
PT2102H1	.490	2- 1/8	1
PT2101FH2	.490	2-17/32	7/8
PT2103FH1	.490	2-17/32	1-1/8
PT2106FH2	.490	2-63/64	7/8
PT2108FH1	.490	2-63/64	1-1/8
PT2161H1	.490	3- 9/64	7/8
PT2163H1	.490	3- 9/64	1-1/8
PT2189H1	.490	3-13/64	7/8
PT2191H1	.490	3-13/64	1-1/8
PT2127F1	.490	3- 9/16	7/8
PT2129F1	.490	3- 9/16	1-1/8
PT2166FH1	.490	3-49/64	7/8
PT2168FH1	.490	3-49/64	1-1/8
PT2127H1	.490	4- 5/64	7/8
PT2129H1	.490	4- 5/64	1-1/8