

TAPER ATTACHMENT
10", 13", 14½", 16" AND 16-24"

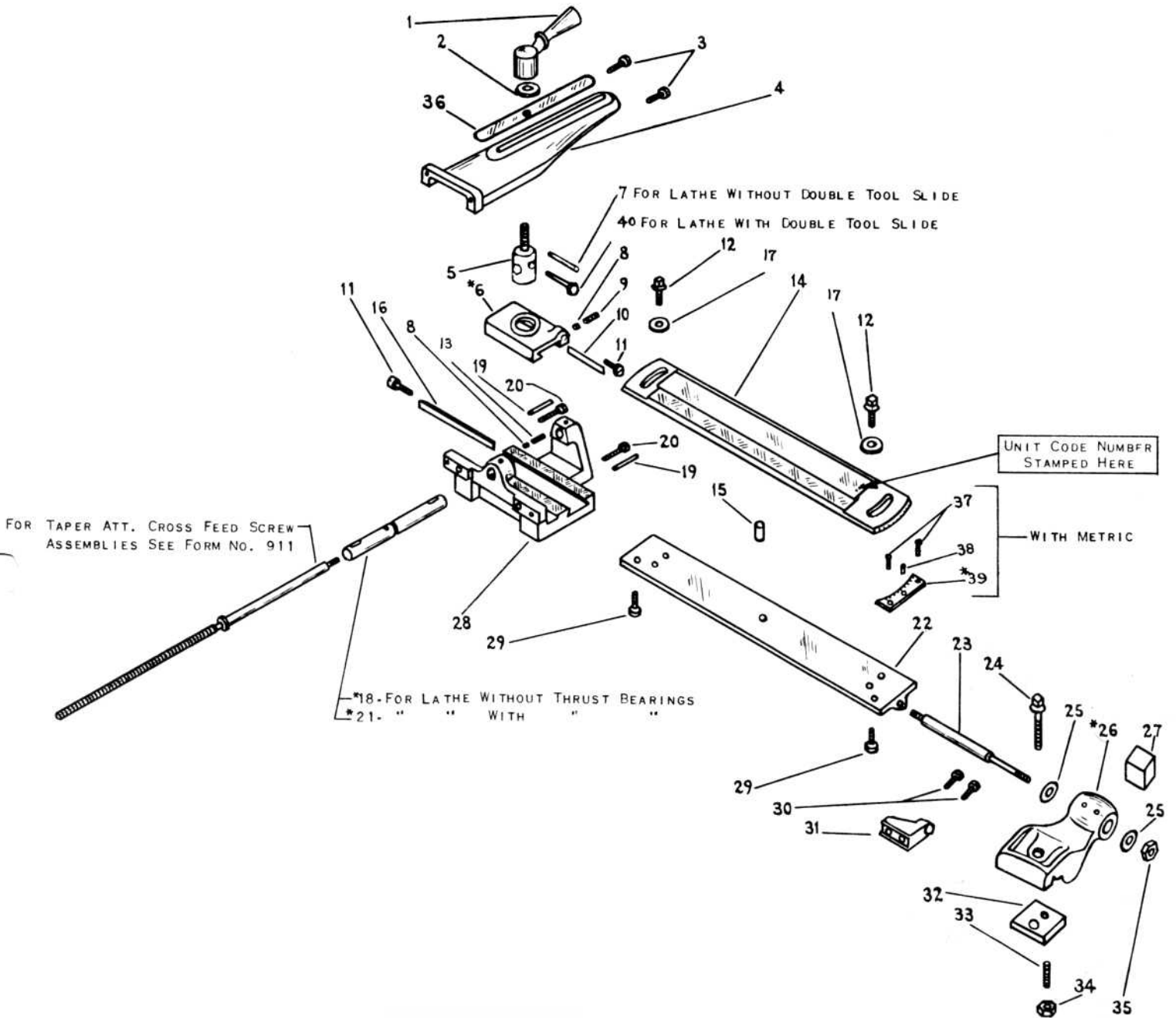

*AVAILABLE ONLY AS SUB-ASSEMBLY. PARTS INCLUDED ARE INDICATED BY THE ITEM NUMBERS APPEARING IN PARENTHESIS AFTER PART NAME.

SERIAL NUMBER OF LATHE AND UNIT CODE NUMBER "MUST" ACCOMPANY ORDER. SEE APRON SHEET FOR LOCATION OF CODE NUMBER.

Item No.	Part Name	10" Part No.	13" Part No.	14-1/2" Part No.	16" & 16/24" Part No.
1	Binding Lever	PT873R1	PT54FH1	PT54FH1	PT54FH1
2	Washer	PT857NR2	PT857H2	PT857H2	PT857H2
3	Screw	PT1166R	PT1167T	PT1168FH	PT1168FH
4	Connecting Bar	PT868R2	PT868T2	PT868F2	PT868H2
5	Binder Stud	PT867R1	PT867TF1	PT867TF1	PT867H1
6	Slide Block (8-9-10-11)	* AS861R1	* AS861TF1	* AS861TF1	* AS861H1
7	Taper Pin	168 x 310	168 x 412	168 x 412	168 x 514
8	Shoe	PT1082NT1	PT1077TH1	PT1077TH1	PT1077TH1
9	Set Screw	122 x 205	122 x 505	122 x 505	122 x 505
10	Slide Block Gib	PT870R1	PT870TF1	PT870TF1	PT870H1
11	Gib Screw	PT219R1	PT219TH1	PT219TH1	PT219TH1
12	Collar Screw	PT872R1	PT872T1	PT872F1	PT872H1
13	Set Screw	122 x 205	122 x 507	122 x 507	122 x 508
14	Swivel Bar	PT869R1	PT869TF1	PT869TF1	PT869H1
15	Pin	160 x 197	160 x 197	160 x 197	160 x 197
16	Bed Bracket Gib	PT859R1	PT859TF1	PT859TF1	PT859H1
17	Washer	PT857NR2	PT857TF2	PT857TF2	PT857H2
18	C.F. Scr. Sleeve (5-7)	* AS858R1	* AS858TF1	* AS858TF1	* AS858H1
19	Pin	160 x 82	160 x 119	160 x 119	160 x 119
20	Cap Screw	112 x 320	112 x 424	112 x 428	112 x 428
21	C.F. Scr. Sleeve (5-7)	* AS858R2	* AS858TF2	* AS858TF2	* AS858H2
22	Taper Att. Bed.	PT860R1	PT860TF1	PT860TF1	PT860H1
23	Tie Rod	PT865R1	PT865T2	PT865F1	PT865H2
24	Collar Screw	PT210R1	PT871T1	PT871F1	PT871H1
25	Washer	PT875RT1	PT875RT1	PT875FH1	PT875FH1
26	Tie Rod Brkt. (24-27-32-33-34)	* AS864R1	* AS864T1	* AS864F1	* AS864H1
27	Babbitt	506 x 6	506 x 6	506 x 6	506 x 6
28	Bed Bracket	PT862R1	PT862TF1	PT862TF1	PT862H1
29	Cap Screw	111 x 110	111 x 210	111 x 210	111 x 212
30	Cap Screw	111 x 114	111 x 116	111 x 116	111 x 116
31	Stop	PT855R1	PT855T1	PT855FH1	PT855FH1
32	Bracket Clamp	PT863NR1	PT863TF1	PT863TF1	PT863H1
33	Set Screw	126 x 624	126 x 624	126 x 624	126 x 628
34	Jam Nut	PT1072-2	PT1072-2	PT1072-2	PT1072-2
35	Hex Nut	PT1051NF1	PT1051NF1	PT1052FH1	PT1052FH1
36	Chip Guard	CL3285R	CL3285T	CL3285FH	CL3285FH
37	Screw	103 x 8	103 x 8	103 x 8	103 x 8
38	Pin	160 x 19	160 x 19	160 x 19	160 x 19
39	Metric Grad. Plate (37-38)	* AS2239R1	* AS2239TF1	* AS2239TF1	* AS2239H1
40	Locking Pin	AS487R1	AS487TF1	- - - - -	AS487H1