

SERIAL NUMBER OF LATHE AND UNIT
CODE NUMBER "MUST" ACCOMPANY ORDER

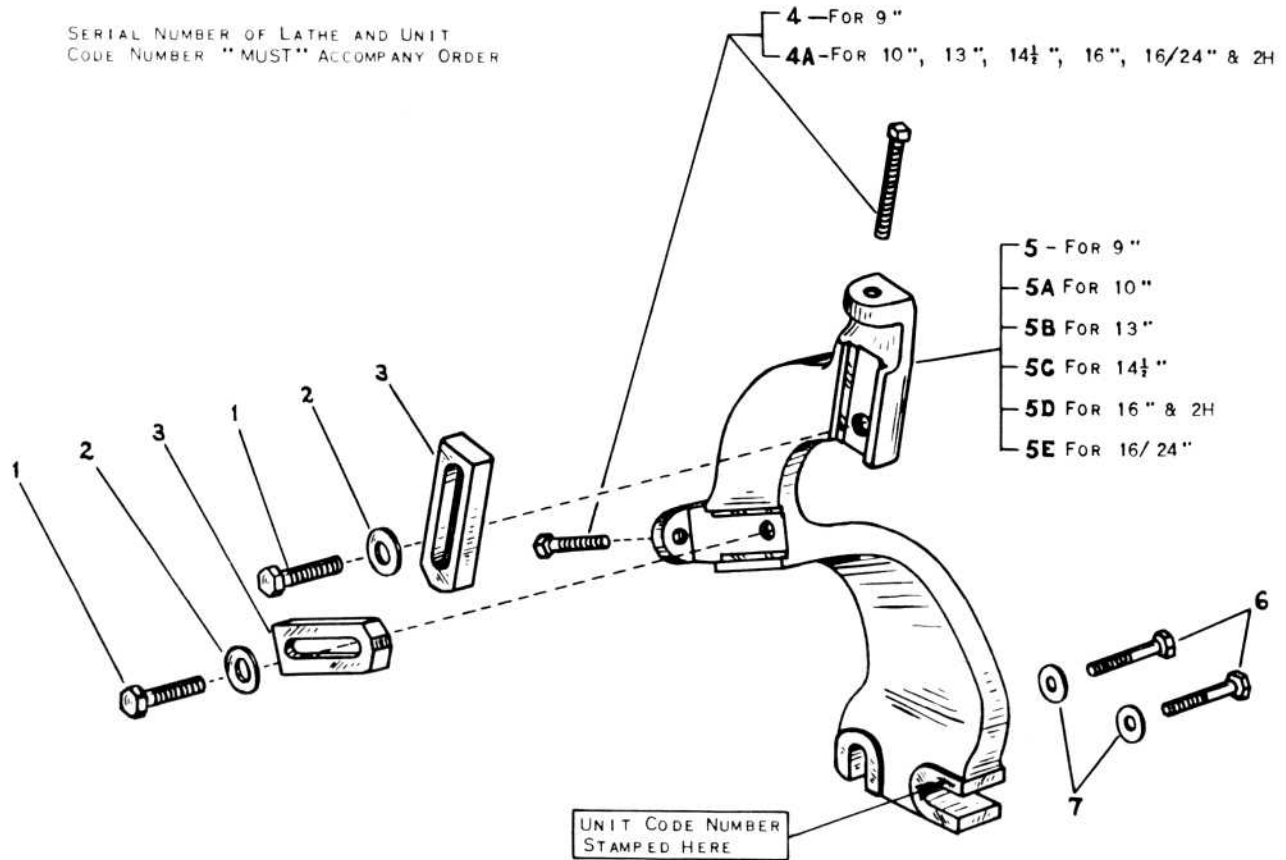

REGULAR FOLLOWER REST
 FOR 9", 10", 13", 14½", 16", 16/24" & 2H

* AVAILABLE ONLY AS SUB-ASSEMBLY. PARTS INCLUDED ARE INDICATED BY THE ITEM NUMBERS APPEARING IN PARENTHESIS AFTER PART NAME.

ITEM NO.	PART NAME	9" & 10" (1' Col.)		13"		14½", 16", 16/24" & 2H	
		PART NO.		PART NO.		PART NO.	
1	HEX. CAP SCREW	112X116		112X220		112X220	
2	WASHER	161X12		161X17		161X17	
3	JAW	PT128NR1		PT128T1		PT128FH1	
4	SQ. HD. CAP SCREW	118X128		- - -		- - -	
4A	" " " " " "	118X136		118X240		118X248	
5	FRAME	PT130N1		- - -		- - -	
5A	FRAME	PT130R1		- - -		- - -	
5B	FRAME	- - -		PT130T1		- - -	
5C	FRAME	- - -		- - -		PT130F1	
5D	FRAME	- - -		- - -		PT130H1	
5E	FRAME	- - -		- - -		PT2010H1	
6	HEX. CAP SCREW	112X132		112X228		112X432	
7	WASHER	161X63		161X64		161X65	

SERIAL NUMBER OF LATHE AND UNIT
CODE NUMBER "MUST" ACCOMPANY ORDER

TELESCOPING JAW FOLLOWER REST

FOR 9", LIGHT 10, 10", 13", 14½", 16", 16/24" & 2H

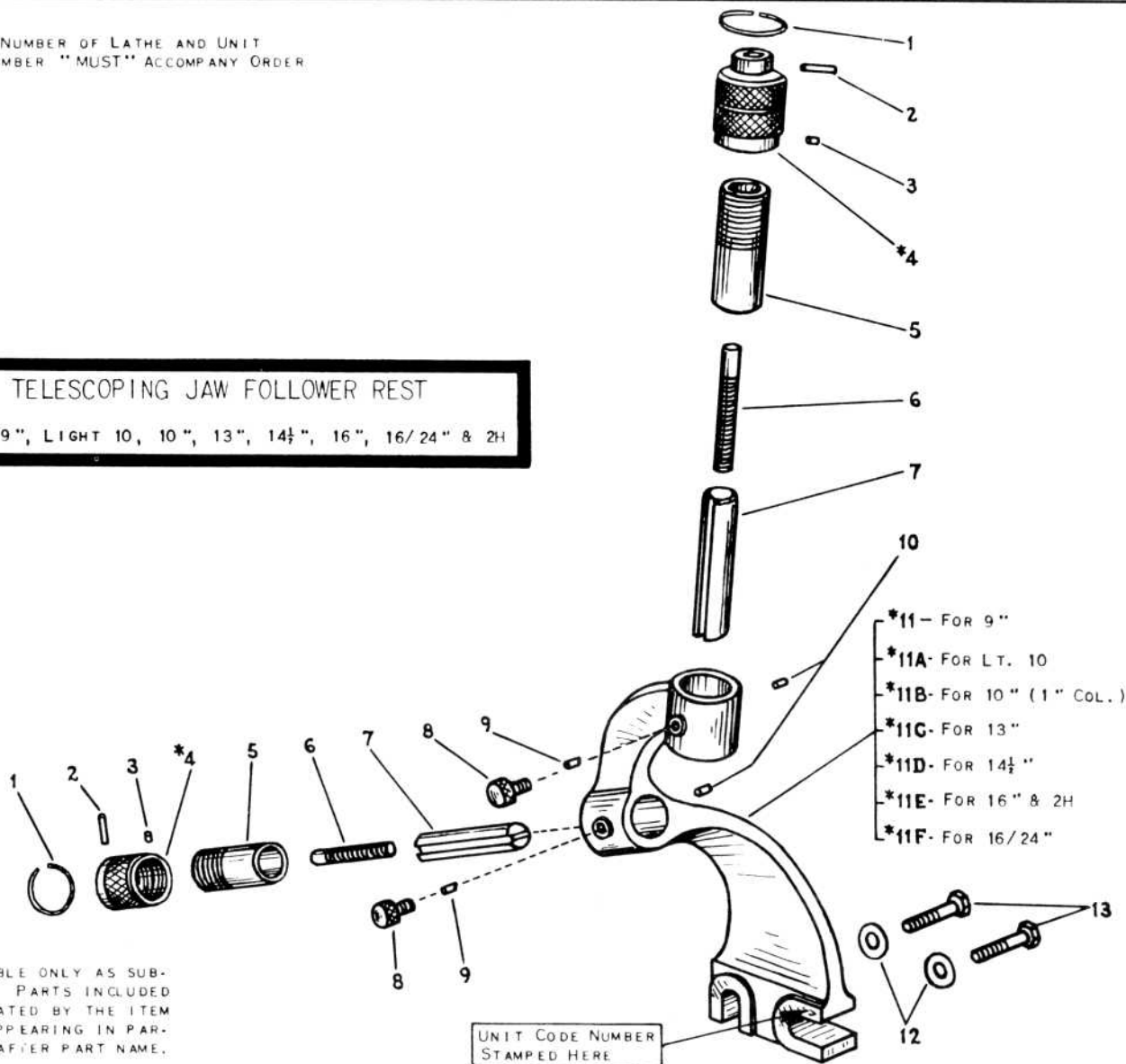

* AVAILABLE ONLY AS SUB-ASSEMBLY. PARTS INCLUDED ARE INDICATED BY THE ITEM NUMBERS APPEARING IN PARENTHESIS AFTER PART NAME.

ITEM NO.	PART NAME	9", LT. 10 & 10" (1 Col)		13"		14½", 16", 16/24" & 2H	
		PART NO.		PART NO.		PART NO.	
1	SNAP RING	PT135NR1		PT135T1		PT135FH1	
2	PIN	160x25		160x54		160x55	
3	SHOE	PT1082NT1		PT1082NT1		PT1082FH1	
4	ADJUSTMENT KNOB (1-2-3-6)	*AS132NR1		*AS132T1		*AS132FH1	
5	ADJ. KNOB SLEEVE	PT131NR1		PT131T1		PT131FH1	
6	JAW ADJ. SCREW	PT133NR1		PT133T1		PT133FH1	
7	JAW	PT129NR1		PT129T1		PT129FH1	
8	LOCK SCREW	PT134NR1		PT134TH1		PT134TH1	
9	KEY	PT137NR1		PT137TH1		PT137TH1	
10	PIN	160x46		160x47		160x47	
11	FRAME (5-10)	*AS120N1		- - -		- - -	
11A	FRAME (5-10)	*AS120K1		- - -		- - -	
11B	FRAME (5-10)	*AS120R1		- - -		- - -	
11C	FRAME (5-10)	- - -		*AS120T1		- - -	
11D	FRAME (5-10)	- - -		- - -		*AS120F1	
11E	FRAME (5-10)	- - -		- - -		*AS120H1	
11F	FRAME (5-10)	- - -		- - -		*AS2009V1	
12	WASHER	161x63		161x17		161x65	
13	CAP SCREW	112x132		112x228		112x432	