

SERIAL NUMBER OF LATHE AND UNIT
CODE NUMBER "MUST" ACCOMPANY ORDER

SQUARE TURRET TOOL BLOCK
FOR 9", 10-K, 10",
13", 14 1/2", 16", 16/24" AND 17"

ITEM NO.	PART NAME	9", 10-K, 10" & 13"	14 1/2", 16", 16/24", 17"
		PART NO.	PART NO.
1	SET SCREW	121x116	121x320
2	SQUARE TURRET	PRICE ON REQUEST	PRICE ON REQ
3	TOOL ADJ. WEDGE	PT744NT2	PT744FH2
4	INDEX PILOT	PT759NT1	PT759FH1
5	WASHER	180x300	PT3400
6	CAP SCREW	114x12	114x120
7	CAP SCREW	114x212	114x424
8	PIN	160x258	160x258
9	PIN	160x28	160x59
10	SET SCREW	122x102	122x102
11	BASE	PT740NT2	PT740FH2
12	ORDER ITEM 22	PT751NT2	PT751FH2
13	EXPANSION PLUG	PT1502	PT1503
14A	RAISING BLOCK 9" LATHE	PT762N1	- - - -
14B	" " " " LT. 10 "	PT762K1	- - - -
14C	" " " " 10" "	PT762R1	- - - -
14D	" " " " 13" "	PT762T1	- - - -
14E	" " " " 14 1/2" "	- - - -	PT762F1
14F	" " " " 16"-16/24"	- - - -	PT762H1
15	HEX. WRENCH	CE2385	CE2387
16	HEX. WRENCH	CE2389	CE2390
17	MACH. SCREW	107x110	107x316
18	ADJUSTING SCREW	PT761NT1	PT761FH1
19	CLAMP SHOE - LEFT	PT764NT1	PT764FH1
20	CLAMP SHOE - RIGHT	PT763NT1	PT763FH1
21	PIN	160x25	160x33
22	ECCENTRIC (12-21-23-24)	*AS758NT1	*AS758FH1
23	HANDLE	PT750NT1	PT750FH2
24	BAKELITE BALL	PT406NT1	PT406K&FH1
25	RAISING BLOCK		PT6734GJ1

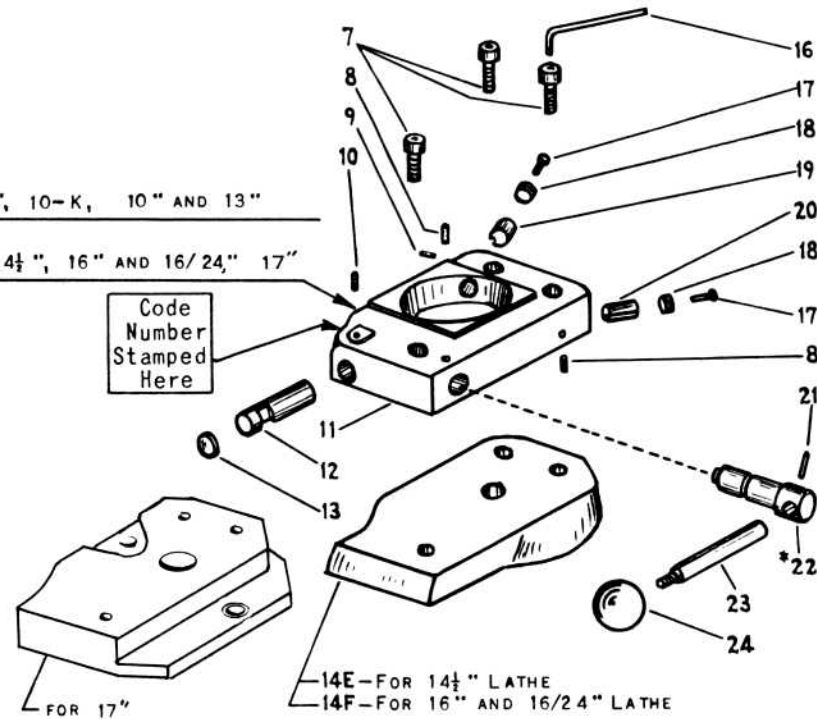
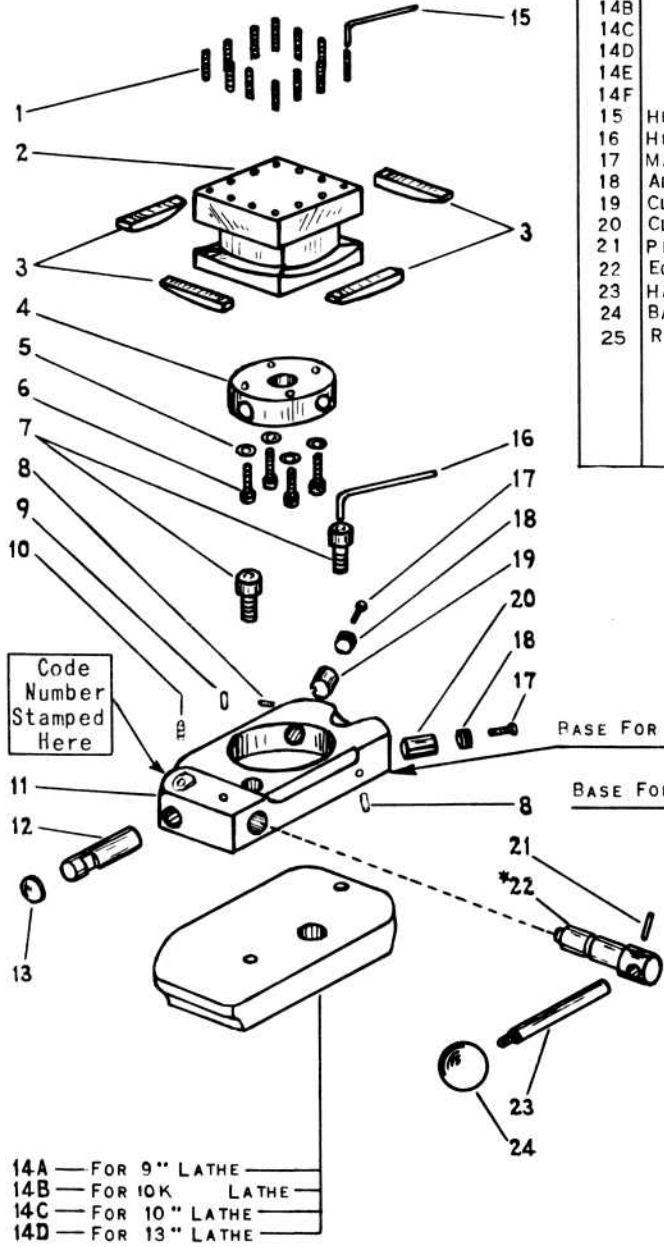

* AVAILABLE ONLY AS SUB-ASSEMBLY. PARTS INCLUDED ARE INDICATED BY THE ITEM NUMBERS APPEARING IN PARENTHESIS AFTER PART NAME.

SERIAL NUMBER OF LATHE AND UNIT
CODE NUMBER "MUST" ACCOMPANY ORDER

ITEM NO.	PART NAME	9", 10K, 10" & 13"		16" & 2H	
		PART NO.		PART NO.	
1	SET SCREW	121x116		121x320	
2	SQUARE TURRET	PRICE ON REQUEST		PRICE ON REQUEST	
3	TOOL ADJ. WEDGE	PT744NT2		PT744FH2	
4	INDEX PILOT	PT759NT1		PT759FH1	
5	WASHER	180x300		PT3400	
6	CAP SCREW	114x12		114x120	
7	CAP SCREW - FOR 9", 10", 13" & 16"	114x212		114x424	
7A	CAP SCREW - FOR LT. 10	114x220		- - - -	
8	PIN	160x258		160x258	
9	PIN	160x28		160x59	
10	SET SCREW	122x102		122x102	
11	BASE	PT740NT2		PT740FH2	
12	ORDER ITEM 27	PT751NT1		PT751FH2	
13	EXPANSION PLUG	PT1502		PT1503	
14	CAP SCREW	114x228		- - - -	
15	PLATE - FOR LT. 10	PT770K1		- - - -	
15A	PLATE - FOR 13"	PT770T2		- - - -	
16	R. B. BINDING NUT	PT772T1		- - - -	
17	HEX. WRENCH	CE2385		CE2387	
18	HEX. WRENCH	CE2389		CE2390	
19	MACHINE SCREW	107x110		107x316	
20	ADJUSTING SCREW	PT761NT1		PT761FH1	
21	CLAMP SHOE - LEFT	PT764NT1		PT764FH1	
22	CLAMP SHOE - RIGHT	PT763NT1		PT763FH1	
23	TEE SLOT NUT	PT741NR2		PT741FH1	
24	PIN	160x25		160x33	
25	HANDLE	PT750NT1		PT750FH2	
26	BAKELITE BALL	PT406NT1		PT406K&FH1	
27	ECCENTRIC (12-24-25-26)	*AS758NT1		*AS758FH1	
28	TURRET KEY	- - - -		PT753FH1	
29	MACH. SCREW	- - - -		103x208	

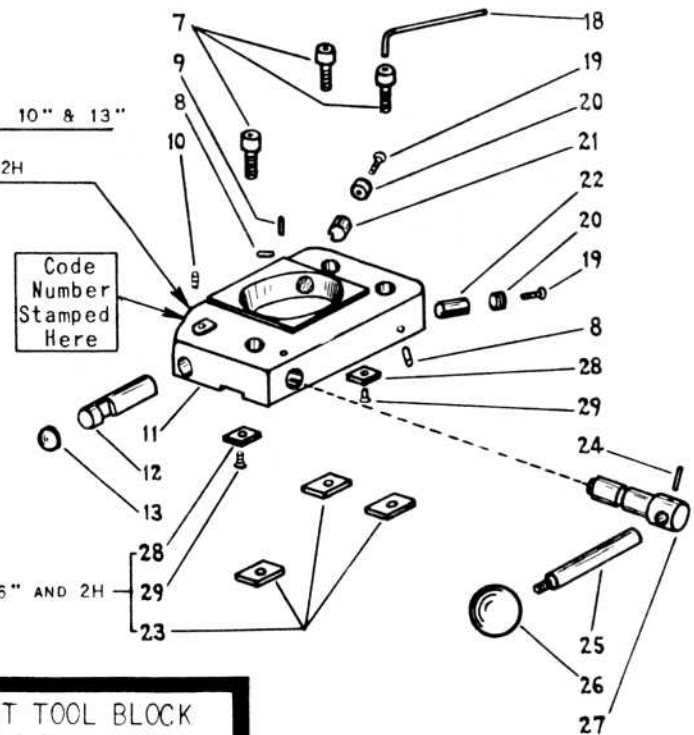
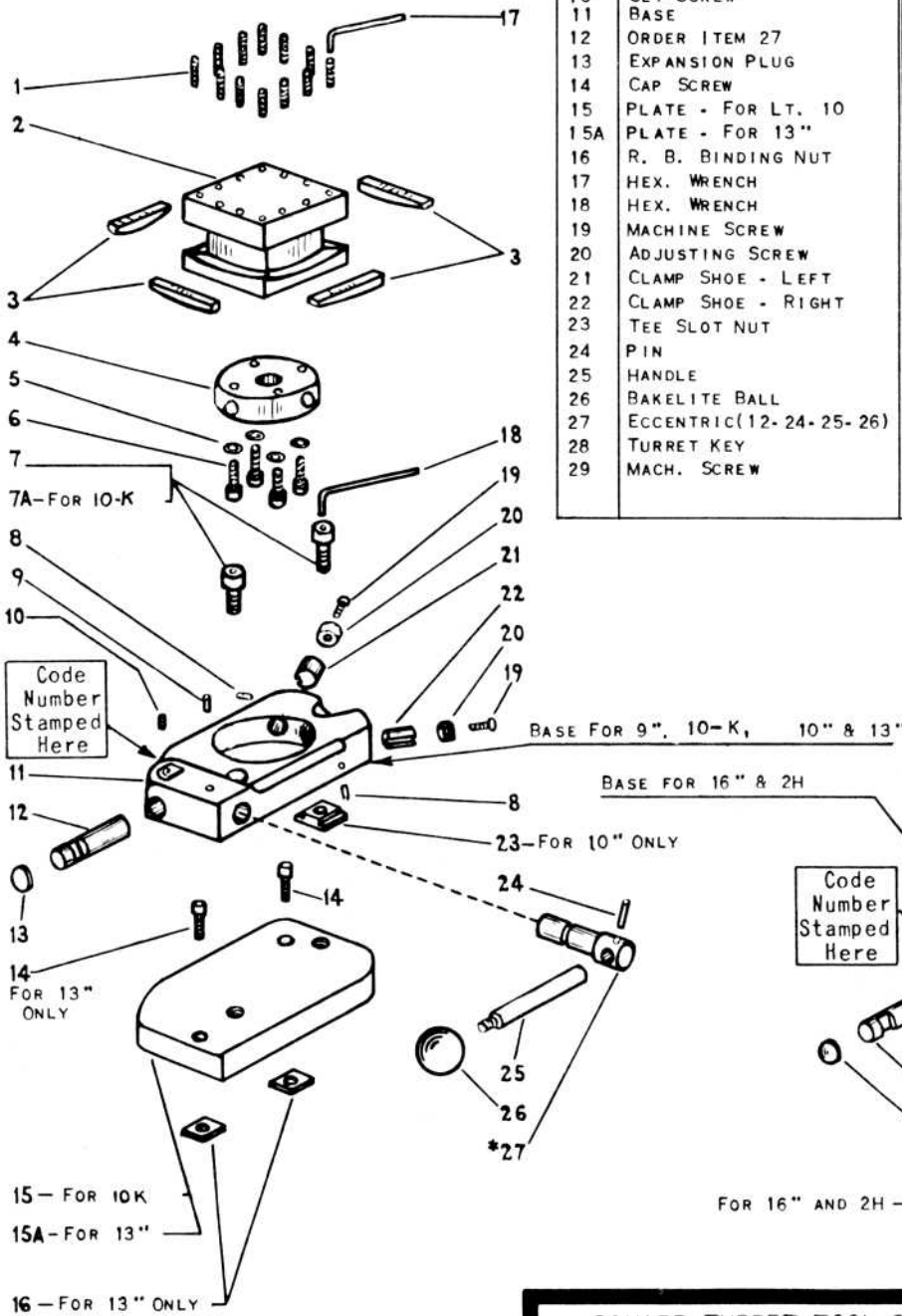

SQUARE TURRET TOOL BLOCK
for Double Tool Cross Slide
FOR 9", 10-K, 10", 13", 16" AND 2H

* AVAILABLE ONLY AS SUB-ASSEMBLY. PARTS INCLUDED ARE INDICATED BY THE ITEM NUMBERS APPEARING IN PARENTHESIS AFTER PART NAME.