

SERIAL NUMBER OF LATHE AND UNIT CODE NUMBER 'MUST' ACCOMPANY ORDER.

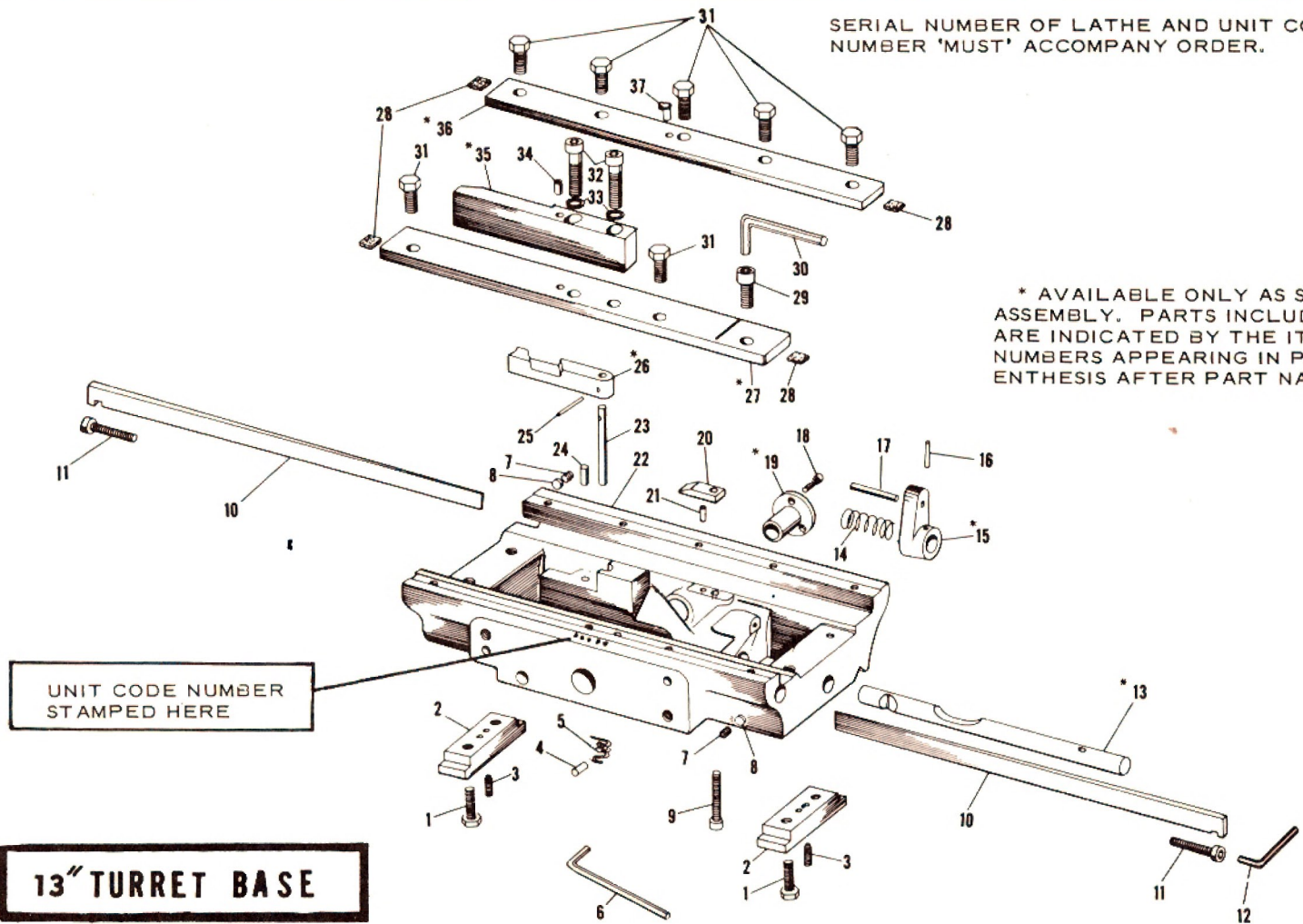

* AVAILABLE ONLY AS SUB-ASSEMBLY. PARTS INCLUDED ARE INDICATED BY THE ITEM NUMBERS APPEARING IN PARENTHESIS AFTER PART NAME.

ITEM NO.	PART NAME	PART -NO.	NO. REQD.	
1	CAP SCREW	112 X 436	4	
2	CLAMP	PT3003T1	2	
3	SET SCREW	121 X 320	4	
4	PIN	PT1815	1	
5	INDEX LEVER SPRING	PT3028T1	1	
6	HEX WRENCH	CE2392	1	
7	SET SCREW	120 X 4	2	
8	SHOE	PT107BRH1	2	
9	CAP SCREW	114 X 34	1	
10	SIDE GIB	PT3036T1	2	
11	GIB SCREW	PT219TH1	2	
12	HEX WRENCH	CE2387	1	
13	FEED STOP SHAFT (16)	*AS3031T1	1	
14	SPRING	162 X 59	1	
15	STOP SCREW STOP (16-17)	*AS3007T1	1	
16	TAPER PIN	168 X 410	1	
17	STRAIGHT PIN	160 X 39	1	
18	CAP SCREW	114 X 712	4	
19	TURNSTILE SHAFT BUSHING (18)	*AS3453T1	1	
20	LOCK BOLT CAM	PT3020T1	1	
21	STRAIGHT PIN	160 X 74	1	
22	TURRET BASE	WRITE FOR INFORMATION		
23	INDEX LEVER PIN	PT3027T1	1	
24	STRAIGHT PIN	160 X 236	1	
25	TAPER PIN	168 X 208	1	
26	TURRET INDEXING LEVER (4-5-23-25)	*AS3026T1	1	
	CONTINUED ON REVERSE SIDE			

ITEM NO.	PART NAME	PART NO.	NO. REQD.
27	HORIZONTAL GIB, FRONT (28)	*AS3441T1	1
28	FELT	PT3464T1	4
29	SOC. HD. CAP SCREW	114 X 216	1
30	HEX WRENCH	CE2389	1
31	CAP SCREW	PT3136T1	7
32	CAP SCREW	114 X 228	2
33	WASHER	PT1684-1	2
34	BALL OILER	155 X 14	1
35	RELEASE CAM (34)	*AS3445T1	1
36	HORIZONTAL GIB, REAR (28-37)	*AS3440T1	1
37	OILER	155 X 21	1

** WRITE FOR INFORMATION

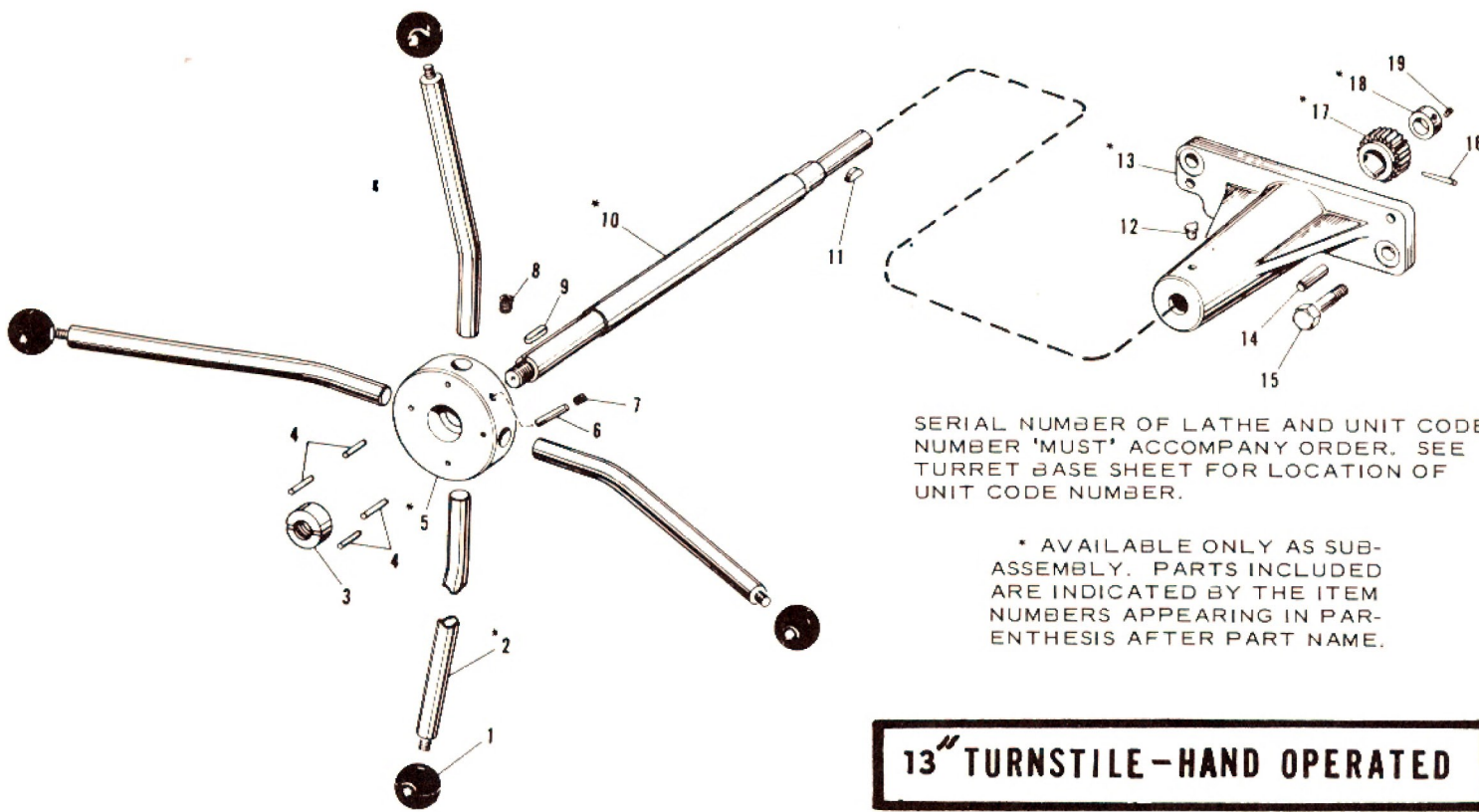

SERIAL NUMBER OF LATHE AND UNIT CODE NUMBER 'MUST' ACCOMPANY ORDER. SEE TURRET BASE SHEET FOR LOCATION OF UNIT CODE NUMBER.

* AVAILABLE ONLY AS SUB-ASSEMBLY. PARTS INCLUDED ARE INDICATED BY THE ITEM NUMBERS APPEARING IN PARENTHESIS AFTER PART NAME.

13" TURNSTILE - HAND OPERATED

ITEM NO.	PART NAME	PART NO.	NO. REQD.
1	BAKELITE BALL	PT406K & FH1	4
2	TURNSTILE HANDLE (1-4)	*AS3044T1	4
3	TURNSTILE NUT	PT3142H1	1
4	TAPER PIN	168 X 409	4
5	TURNSTILE HUB (4-6-7-8)	*AS3043T1	1
6	PIN	160 X 80	1
7	HD'LESS CUP PT SET SCREW	122 X 605	1
8	HOLL HD CUP PT SET SCREW	120 X 206	1
9	KEY (ONE END ROUND)	164 X 11	1
10	TURNSTILE SHAFT(HAND FEED)(9-11)	*AS3140T1	1
11	WOODRUFF KEY	PT2072	1
12	GITS OILER	155 X 20	1
13	TURNSTILE BRACKET (12)	*AS3141T1	1
14	DOWEL	153 X 5	2
15	HEX HD CAP SCREW	112 X 416	2
16	TAPER PIN	168 X 212	1
17	RACK PINION (16)	*AS3034T1	1
18	TURNSTILE SHAFT COLLAR (19)	*AS3454T1	1
19	SET SCREW	120 X 4	1