

PARTS LIST

FORM 908-C
ALL MODELS

HEADSTOCK

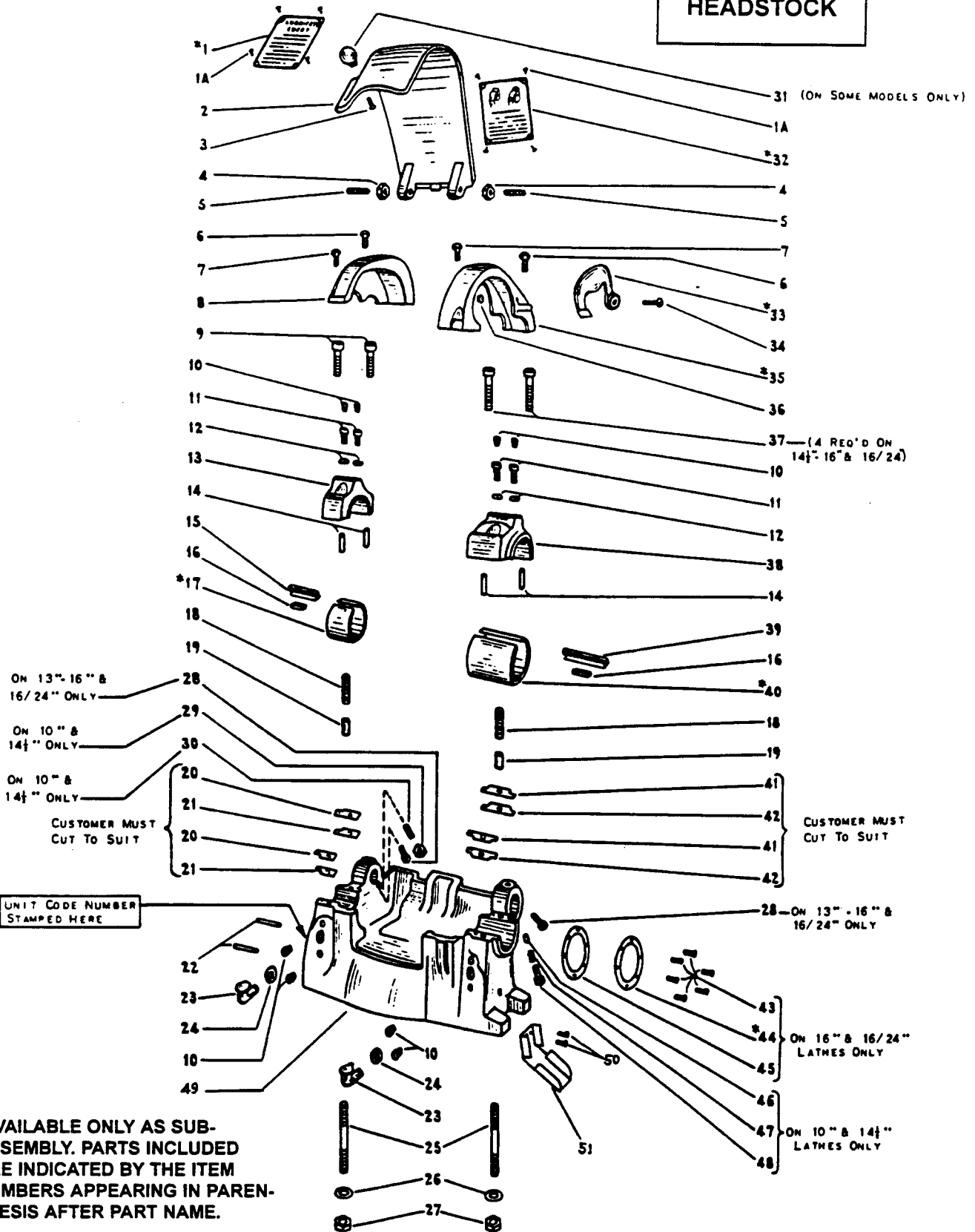

ITEM NO.	PART NAME	10"	13"	14 1/2"	16" & 16/24"
		PART NO.	PART NO.	PART NO.	PART NO.
1A	DRIVE SCREW	130x103	130x103	130x103	130x103
1	LUBRI. CHART (1A)	*AS441-4	*AS441-4	*AS441-4	*AS441-4
2	CONE COVER	PT2576R1	PT2576T1	NLA	PT2576H1
3	KNOB SCREW	****	****	103x1012	103x1012
4	JAM NUTS	139x23	139x27	139x25	139x27
5	SET SCREW	PT700R1	PT702TH1	NLA	PT702TH1
6	GUARD SCREW (REAR)	101x614	101x614	PT1154FH1	PT1154FH1
7	GUARD SCREW (FRONT)	101x616	114x16	101x716	PT388T1
8	QUILL GUARD	PT2580R1	PT2580T1	PT2580F1	PT2580H1
9	CAP SCREW	114x224	114x424	114x432	114x432
10	PIPE PLUG	152x73	152x73	152x73	152x73
11	EXPANDER SCREW	PT1165RH1	PT1165RH1	PT1165RH1	PT1165RH1
12	LOCK WASHER	180x103	180x103	183x103	180x103
13	SMALL BRG. CAP	PT12R2	PT12T3	PT12F3	PT12H3
	(NOT A SERVICE ITEM)				
14	DOWEL	153x1	153x2	153x4	153x4
15	BRG. EXPANDER	PT523R1	PT523T1	NLA	PT523H2
16	EXPANDER WICK	256x13	256x13	256x13	256x13
17	SLEEVE BEARING, SMALL	*AS512R2	*AS512T3	*AS512F3	*AS512H3
	(11-12-15-16-18-20-21)				
18	CAPILLARY OILER	AS373KH2	AS373KH2	AS373KH2	AS373KH2
19	OILER TUBE	PT522R1	PT522TH2	PT522TH2	PT522TH2
20	BRASS SHIM	PT366R1	PT366T2	PT366F2	PT366H1
21	LAMINATED SHIM	PT365R2	PT365T3	PT365F3	PT375H2
22	PIN	160x105	160x105	160x142	160x142
23	OILER	PT2678RH1	PT2678RH1	PT2678RH1	155x42
24	OILER FLANGE	PT386R1	PT386TH1	PT386TH1	PT386TH1
25	CLAMPING STUD	PT385R1	PT385TF1	PT385TF1	PT385H2
26	WASHER	161x30	161x36	161x37	161x44
27	NUT	138x31	138x35	138x35	138x39
28	SET SCREWS	****	PT246T1	****	PT246H1
29	JAM NUT	139x26	****	139x26	****
30	SET SCREW	PT4499K1	****	NLA	****
31	COVER KNOB	****	****	PT2579FH1	PT2579FH1
32	BEARING PLATE (1A)	*AS532RH2	*AS532RH2	*AS532RH2	*AS532RH2
33	PLUNGER GUARD (34-36)	*AS362R2	*AS362T2	*AS362F2	*AS362H2
34	SCREW	101x612	101x614	101x714	101x716
35	BULL GEAR GUARD (33)	*AS2581R1	*AS2581T1	NLA	*AS2581H1
36	JAM NUT	139x23	139x23	139x25	139x25
37	CAP SCREW	114x228	114x424	114x432	114x436
38	LARGE BRG. CAP	PT11R2	PT11T2	NLA	PT11H4
	(NOT SERVICE ITEM)				
39	BRG. EXPANDER	PT524R1	PT524T1	PT524F1	PT524H2
40	SLEEVE BEARING, LARGE	*AS511R2	*AS511T2	*AS511F2	*AS511H3
	(11-12-16-18-39-41-42)				
41	BRASS SHIM	PT364R1	PT364T1	PT364F1	PT364H1
42	LAMINATED SHIM	PT363R2	PT363T2	NLA	PT363H2
43	SCREW	****	****	****	104x206
44	PROTECTING RING (43-45)	****	****	****	AS451H2
45	GASKET	****	****	****	PT450H2
46	BINDER SHOE	PT1075NR	****	NLA	****
47	SPRING	PT374NR1	****	PT374F1	****
48	SQ. HD. SCREW	120x156	****	PT376F1	****
49	HEADSTOCK		****	****	****
50	SCREW	132x1402	132x1402	132x1402	132x1402
51	OIL TROUGH	PT2505R4	PT2505T1	NLA	PT2505H1

PARTS LIST

FORM 909-E
ALL MODELS

HEADSTOCK

10", 13", 14-1/2", 16" & 16-24"

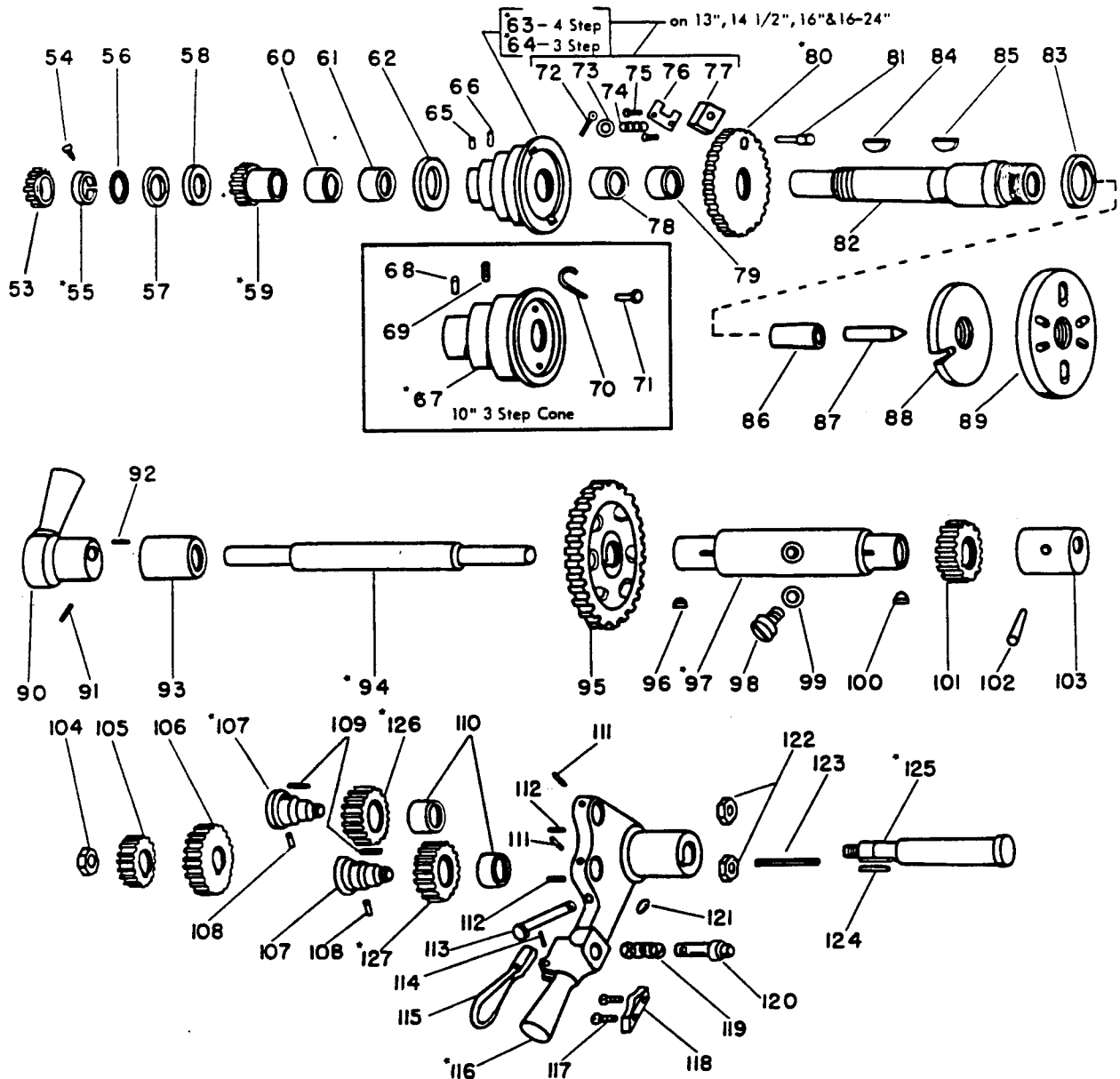

SERIAL NUMBER OF LATHE AND UNIT CODE NUMBER "MUST" ACCOMPANY ORDER.

*AVAILABLE ONLY AS SUB-ASSEMBLY. PART INCLUDED ARE INDICATED BY THE ITEM NUMBERS APPEARING IN PARENTHESIS AFTER PART NAME.

FORM 909E CONT

ITEM NO.	PART NAME	10" PART NO.	13" PART NO.	14 1/2" PART NO.	16" & 16/24" PART NO.
53	SPINDLE GEAR	PT30R1	PT30T2	NLA	PT30H1
54	TAKE UP NUT SCREW	PT382RF1	PT382RF1	PT382RF1	PT382H1
55	TAKE UP NUT (54,66)	*AS25R1	*AS25RF2	*AS25RF2	*AS25H1
56	WASHER	AS26R1	****	****	****
57	THRUST BEARING	****	PA191T1	PT207FH1	****
58	THRUST BEARING	PT207R1	PA190T1	PT207FH1	PT207FH1
59	CONE PINION (80)	*AS17R2	*AS17T4	*AS17F4	*AS17H2
60	OILITE CONE BEARING	PT3669T1	PT3669T1	NLA	PT3669H1
61	OILITE CONE BEARING	****	****	NLA	PT3669H1
62	CONE FLANGE	PT29R1	PT29T1	NLA	PT29H1
63	SPINDLE CONE 4 STEP	****	*AS14T4	NLA	*AS14H3
64	SPINDLE CONE 3 STEP	****	NLA	NLA	NLA
65	PIN	169x242	169x236	169x236	169x237
66	OIL SCREW	PT381NH1	PT381NH1	PT381NH1	PT381NH1
67	SPINDLE CONE 3 STEP	AS14R3	****	****	****
68	PIN	169x242	****	****	****
69	OIL SCREW	PT381NH1	****	****	****
70	SPRING	PT367NR1	****	****	****
71	PLUNGER	PT214NR2	****	****	****
72	COTTER PIN	****	170x206	170x206	170x206
73	WASHER	****	161x16	161x16	161x16
74	COIL SPRING	****	162x18	162x18	101x206
75	SCREW	****	101x304	101x304	101x206
76	CLAMP GIB	****	PT213TF1	PT213TF1	PT213H2
77	CLAMP	****	PT16TF1	PT16TF1	PT16H1
78	OILITE BUSHING	PT3669T1	PT3669T1	NLA	PT3669H1
79	OILITE CONE BUSHING	****	****	NLA	PT3669H1
80	BULL GEAR	*AS15R1 (70-71)	*AS15T6 (72-73-74-75-76-77-81)	*AS15F5 (72-73-74-75-76-77-81)	*AS15H5 (72-73-74-75-76-77-81)
81	PLUNGER	****	PT214T1	PT214F1	PT214H1
82	H.S. SPINDLE	****	****	****	****
82A	1-1/16" COL. CAP.	PT200R1	****	NLA	PT200H1
82B	1-1/16" COL. CAP.	PT200L1	PT200T2	NLA	NLA
83A	PROTECTING RING (1 7/8-8)	PT370RT1	****	NLA	NLA
83B	PROTECTING RING (2 1/4-8)	PT369LT1	PT369LT1	NLA	NLA
84	KEY	106x404	106x606	106x606	106x1008
85	KEY	106x606	106x606	106x606	106x606
86	SPINDLE SLEEVE	****	****	****	****
	#2 MT 1-1/16" COL. CAP.	NLA	NLA	****	****
	#3 MT 1-1/16" COL. CAP.	NLA	NLA	NLA	NLA
	#2 MT 1-1/16" COL.	CL205L	CL205L	CL205L	CL205L
	#3 MT 1-1/16" COL.	CL205H	CL205H	CL205H	CL205H
87A	CENTER RG. #2 MT	CE2401	CE2401	CE2401	CE2401
87B	#3 MT	CE2402	CE2402	CE2402	CE2402
87C	CARBIDE #2 MT	CE1889	CE1889	CE1889	CE1889
87D	#3 MT	CE1890	CE1890	CE1890	CE1890
88	FACE PLATE	****	****	****	****
	1-1/16" COL. CAP.	NLA	****	NLA	NLA
	1-1/16" COL. CAP.	CL2175L	CL2175Q	NLA	NLA
89	FACE PLATE	****	****	****	****
	1-1/16" COL. CAP.	NLA	****	****	NLA
	1-1/16" COL. CAP.	CL2180L	CE2180Q	CL2180MH	CL2180MH
90	BACK GEAR LEVER	PT24R1	PT24T1	****	PT24H1
91	TAPER PIN	168x313	168x212	168x516	168x314
92	PIN	****	160x50	****	160x50
93	ECC. BUSHING	****	PA21T1	****	PA21H1
94	ECCENTRIC SHAFT (90-91-102-103)	*AS202R1	****	NLA	****
	ECCENTRIC SHAFT (90-91-92-94)	****	*AS202T1	****	*AS202H1
95	QUILL GEAR	PT18R1	PT18T1	NLA	PT18H1
96	KEY	106x404	106x605	106x606	106x606
97	QUILL SLEEVE (95-98-99-100)	*AS19R1	*AS19T1	NLA	*AS19H1
98A	OIL PLUG	NLA PRIOR TO 6/85	NLA PRIOR TO 6/85	NLA PRIOR TO 6/85	NLA PRIOR TO 6/85
98B	OIL PLUG	101x604 AFTER 7/85	101x604 AFTER 7/85	101x604 AFTER 7/85	101x604 AFTER 7/85
99	FIBER WASHER	PT378RH1	PT378RH1	PT378RH1	PT378RH1
100	KEY	106x404	106x605	106x606	106x606
101	QUILL PINION	PT20R1	PT20T1	NLA	PT20H1
102	TAPER PIN	168x313	****	168x514	****
103	ECC. BUSHING	PT438R1	PT438T1	PT438F1	PT438H1
104	HEX NUT	137-31	PT1072-5	PT1072-7	PT1072-7
105	STUD GEAR	SEE GEAR SHEET	SEE GEAR SHEET	SEE GEAR SHEET	SEE GEAR SHEET
106	REVERSE GEAR	PT28R1	PT28T2	PT28F2	PT28H1
107	STUD (123-109-108)	*AS229R1	*AS229T2	NLA	*AS229H2
108	FELT WICK-ROUND	256x7	****	****	256x8
109	FELT WICK-FLAT	****	256x3	256x3	****
110	OILITE BUSHING	****	PT687FH1	****	****
111	PIN	****	160x45	160x45	****
112	FELT WICK	****	256x7	256x7	****
113	OILER	155x48	155x48	155x48	155x48
114	PIN	160x26	160x26	160x30	160x30
115	REVERSE LATCH	PT638RT1	PT638RT1	PT638FH1	PT638FH1
116	REVERSE BRACKET (111-112-114-116-119-120-121-123)	*AS635R2	*AS635T2	NLA	*AS635H1
117	SCREW	103x210	101x612	101x612	162x15
118	REVERSE LOCK	PT642R1	PT642T1	PT642FH1	PT642FH1
119	SPRING	162x13	162x14	162x15	162x15
120	PLUNGER	PT640R1	PT640T1	NLA	PT640H1
121	PLUG	****	PT1502	PT1502	****
122	HEX NUT	139x25	139x27	139x31	139x31
123	FLET WICK	256x3	****	256x3	256x3
124	KEY	164x11	PT636T1	PT636FH3	PT636FH3
125	REVERSE SHAFT (104-124)	*AS637R1	*AS637T1	NLA	*AS637H3
126	TWIN GEAR (110)	PA27R228	PA27T327	NLA	PT27H132
127	TWIN GEAR (110)	PA27R228	PA27T327	NLA	PT27H136
128	BUSHING	PT2660-1	****	****	****

PARTS LIST

FORM 961-A
ALL MODELS

SERIAL NUMBER OF LATHE AND UNIT CODE NUMBER "MUST" ACCOMPANY ORDER. SEE HEADSTOCK SHEET FOR LOCATION OF UNIT CODE.

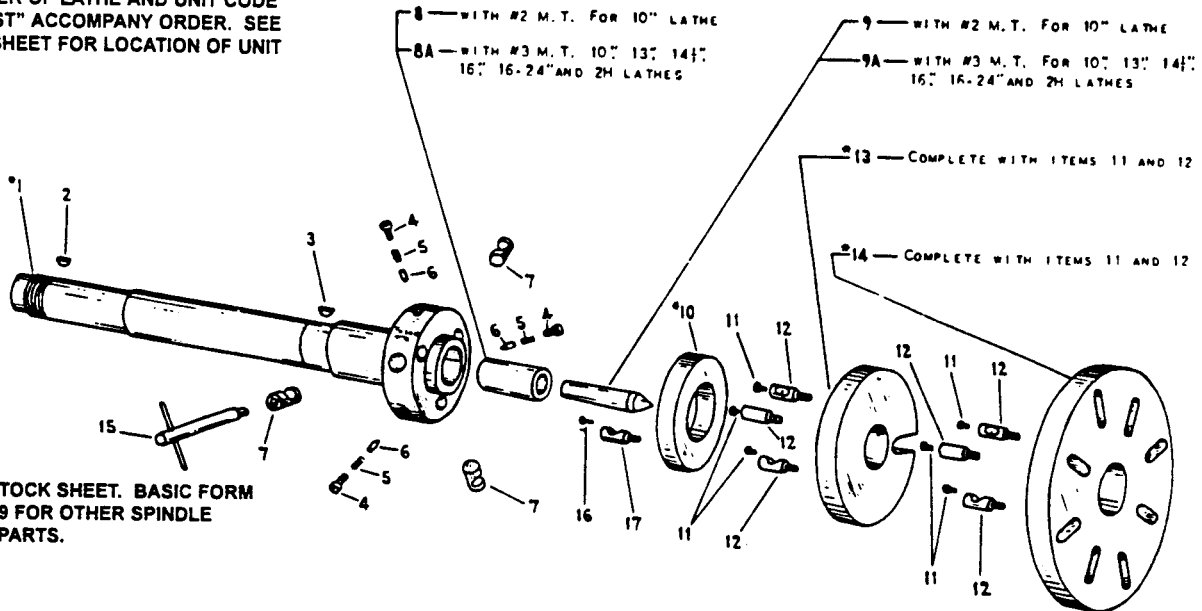

SEE HEADSTOCK SHEET. BASIC FORM NUMBER 909 FOR OTHER SPINDLE ASSEMBLY PARTS.

**TYPE D1 CAM LOCK HEADSTOCK SPINDLE
SIZE-4D1
FOR 10", 13", 14-1/2", 16", 16/24" AND 2H, 1" COLLET LATHES**

*AVAILABLE ONLY AS SUB-ASSEMBLY. PARTS INCLUDED ARE INDICATED BY THE ITEM NUMBERS APPEARING IN PARENTHESIS AFTER PART NAME.

ITEM NO.	PART NAME	10" PART NO.	13" PART NO.	14-1/2" PART NO.	16", 16/24", 2H PART NO.
1	SPINDLE 4" CAM LOCK (2,3,4,5,6,7)	*AS3600L1	*AS3600T1	NLA	*AS3600H1
2	KEY	106x404	106x606	106x606	106x606
3	KEY	106x606	106x606	106x606	106x1008
4	CAP SCREW	114x112	114x112	114x112	114x112
5	DETENT SPRING	PT3639LH1	PT3639LH1	PT3639LH1	PT3639LH1
6	DETENT PLUNGER	PT3638LH1	PT3638LH1	PT3638LH1	PT3638LH1
7	CAM	PT3629LH1	PT3629LH1	PT3629LH1	PT3629LH1
8	SPINDLE SLEEVE #2 M.T.	PT3604L1	*****	*****	*****
8A	SPINDLE SLEEVE #3 M.T.	NLA	PT3605T1	PT3605FH1	PT3605FH1
9	CENTER #2 TAPER	CE2401	*****	*****	*****
9A	CENTER #3 TAPER	CE2402	CE2402	CE2402	CE2402
10	SPINDLE NOSE PROTECTOR (16,17)	*AS3641LH3	*AS3641LH3	*AS3641LH3	*AS3641LH3
11	SCREW	114x8	114x8	114x8	114x8
12	CAM LOCK STUD	PT3626LH1	PT3626LH1	PT3626LH1	PT3626LH1
13	FACE PLATE SMALL (11-12)	CB2175LT	CB2175LT	CB2175FH	CB2175FH
14	FACE PLATE LARGE (11-12)	CB2180L	CB2180T	CB2180FH	CB2180FH
15	WRENCH	PA3638-1	PA3686-1	PA3686-1	PA3686-1
16	SCREW	103x206	103x206	103x206	103x206
17	STUD	PT3642LH1	PT3642LH1	PT3624LH1	PT3624LH1

PARTS LIST

FORM 961-A CON'T
ALL MODELS

SERIAL NUMBER OF LATHE AND UNIT CODE NUMBER "MUST" ACCOMPANY ORDER. SEE HEADSTOCK SHEET FOR LOCATION AND UNIT CODE NUMBER.

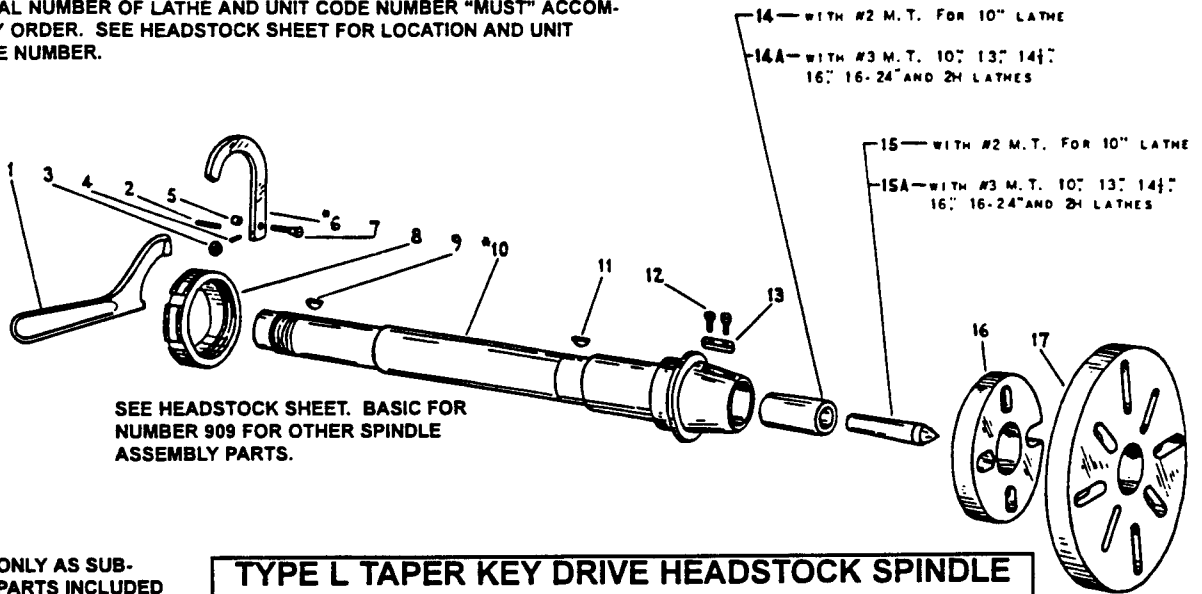

SEE HEADSTOCK SHEET. BASIC FOR NUMBER 909 FOR OTHER SPINDLE ASSEMBLY PARTS.

*AVAILABLE ONLY AS SUB-ASSEMBLY. PARTS INCLUDED ARE INDICATED BY THE ITEM NUMBERS APPEARING IN PARENTHESIS AFTER PART NAME.

**TYPE L TAPER KEY DRIVE HEADSTOCK SPINDLE
SIZE-00**

FOR 10", 13", 14-1/2", 16", 16/24" AND 2H, 1" COLLET LATHES

ITEM NO.	PART NAME	10" PART NO.	13" PART NO.	14-1/2" PART NO.	16", 16/24" & 2H PART NO.
1	WRENCH	PT3724LH1	PT3724LH1	PT3724LH1	PT3724LH1
2	PIN	PT1822	160x90	160x90	160x90
3	NUT	138x17	138x17	138x17	138x17
4	SCREW	120x914	120x914	120x914	120x19
5	SPACER	PT3722L1	PT3722TH1	PT3722TH1	PT3722TH1
6	HINGE WEDGE	PT3721LH2	AS3721TH1	AS3721TH2	AS3721TH2
7	SHOULDER SCREW	PT3723L1	PT3723TH1	PT3723TH1	PT3723TH1
8	DRAW NUT	PT3725LH1	PT3725LH1	PT3725LH1	PT3725LH1
9	KEY	106x404	106x606	106x606	160x606
10	SPINDLE TYPE LOO	PT3700L1	AS3700T1	NLA	AS3700H1
11	KEY	106x606	106x606	106x606	106x1008
12	SPACER	114x605	114x605	114x605	114x605
13	KEY	PT3720LH1	PT3720LH1	PT3720LH1	PT3720LH1
14	SPINDLE SLEEVE #2 M.T.	CL205L	*****	*****	*****
14A	SPINDLE SLEEVE #3 M.T.	CL205H	CL205H	CL205H	CL205H
15	CENTER #2 M.T.	CE2401	*****	*****	*****
15A	CENTER #3 M.T.	CE2402	CE2402	CE2402	CE2402
16	FACE PLATE-SMALL	CA2175L	CA2175T	CA2175FH	CA2175FH
17	FACE PLATE-LARGE	CA2180L	NLA	CA2180FH	CA2180FH