

SADDLE
ENGLISH AND METRIC
FOR 10" 13", 14½", 16" AND 16-24"

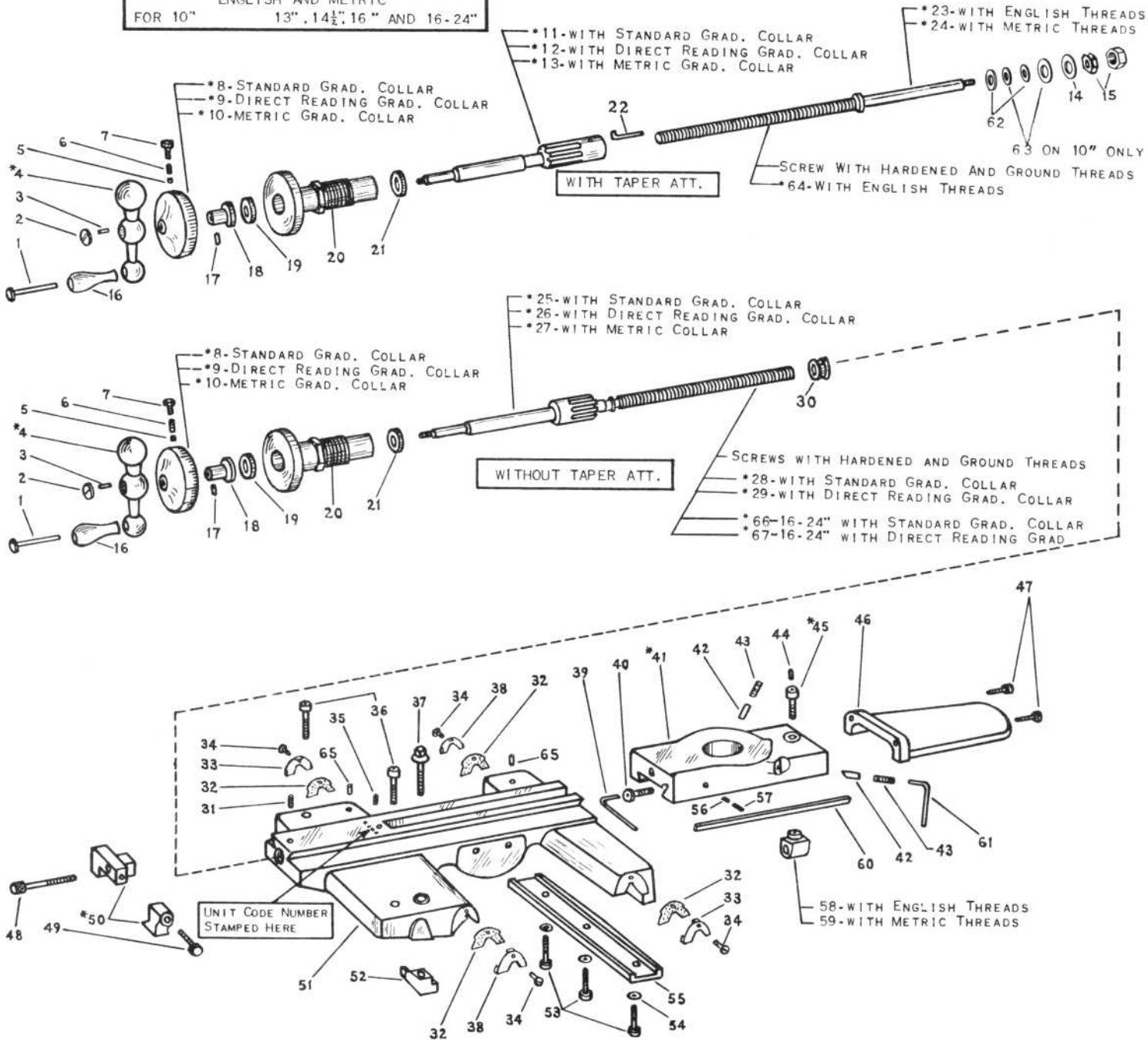

*AVAILABLE ONLY AS SUB-ASSEMBLY. PARTS INCLUDED ARE INDICATED BY THE ITEM NUMBERS APPEARING IN PARENTHESIS AFTER PART NAME.

SERIAL NUMBER OF LATHE AND UNIT CODE NUMBER "MUST" ACCOMPANY ORDER.

STANDARD GRADUATED COLLARS - EACH GRADUATION REPRESENTS A MOVEMENT OF THE CROSS SLIDE OF .001" OR A REDUCTION IN THE DIAMETER OF THE WORK OF .002"

DIRECT READING GRADUATED COLLARS - EACH GRADUATION REPRESENTS A MOVEMENT OF THE CROSS SLIDE OF .0005" OR A REDUCTION IN THE DIAMETER OF THE WORK OF .001"

METRIC GRADUATED COLLARS - EACH GRADUATION REPRESENTS A MOVEMENT OF THE CROSS SLIDE OF 0.02 MM. OR A REDUCTION IN THE DIAMETER OF THE WORK OF 0.04 MM.

ITEM NO.	PART NAME	10"		13"		14 1/2"		16" & 16-24"	
		PART NO.		PART NO.		PART NO.		PART NO.	
1	STUD	PT1241		PT1242		PT1243		PT1243	
2	RETAINING NUT	PT295NR1		PT295T1		PT295FH1		PT295FH1	
3	PIN	160X17		160X19		160X19		160X19	
4	BALL CRANK (1-16)	*AS1264R1		*AS1264T1		*AS1264FH1		*AS1264FH1	
5	SHOE	PT1080NK1		PT1080NK1		PT1080NK1		PT1080NK1	
6	PIN	160X20		160X26		160X26		160X26	
7	THUMB SCREW	PT1857		PT1857		PT1857		PT1857	
8	GRAD. COLLAR (5-6-7)	*AS64R3		*AS64TH3		*AS64TH3		*AS64TH3	
9	GRAD. COLLAR (5-6-7)	*AS1266R2		*AS1266TH2		*AS1266TH2		*AS1266TH2	
10	GRAD. COLLAR (5-6-7)	*AS2232R3		*AS2232TH3		*AS2232TH3		*AS2232TH3	
11	FRONT T. A. SCREW (2-3.*4.*8-17-18-19-20-21-22)	*AS482R2		*AS482T3		*AS482F3		*AS482H3	
12	FRONT T. A. SCREW (2-3.*4.*9-17-18-19-20-21-22)	*ASD482R2		*ASD482T3		*ASD482F3		*ASD482H3	
13	FRONT T. A. SCREW (2-3.*4.*10-17-18-19-20-21-22)	*ASM482R2		*ASM482T3		*ASM482F3		*ASM482H3	
14	COLLAR	PT866R2		PT866TF2		PT866TF2		PT866H2	
15	HEX. NUT	139x25		139x27		139x27		139x31	
16	HANDLE	PT1491		PT1492		PT1493		PT1493	
17	PIN	160X247		160X268		160X268		160X268	
18	C. F. SLEEVE	PT69R1		PT69TH1		PT69TH1		PT69TH1	
19	BEARING, FRONT	AS841R1		AS841H2		AS841H2		AS841H2	
20	C. F. BUSHING	PT63R3		PT63T3		PT63FH3		PT63FH3	
21	BEARING, REAR	AS841R1		AS841T2		AS841H2		AS841H2	
22	KEY	PT484R1		PT484T1		PT484F1		PT484H1	
23	REAR T. A. SCREW (14-15.*45-58)	*AS483R3		*AS483T3		*AS483F3		*AS483H3	
24	REAR T. A. SCREW (14-15.*45-59)	*AS2240R2		*AS2240T2		*AS2240F2		*AS2240H2	
25	CROSS FEED SCREW (2-3.*4.*8-17-18-19-20-21-30.*45-58)	*AS224R3		*AS224T4		*AS224F5		*AS224H5	
26	CROSS FEED SCREW (2-3.*4.*9-17-18-19-20-21-30.*45-58)	*ASD224R3		*ASD224T4		*ASD224F5		*ASD224H5	
27	CROSS FEED SCREW (2-3.*4.*10-17-18-19-20-21-30.*45-59)	*AS2230R2		*AS2230T3		*AS2230F3		*AS2230H3	
28	CROSS FEED SCREW (2-3.*4.*8-17-18-19-20-21-30.*45-58)	*AS6825L1		*AS6825T1		*AS6825F1		*AS6825H1	
29	CROSS FEED SCREW (2-3.*4.*9-17-18-19-20-21-30.*45-58)	*ASD6825L1		*ASD6825T1		*ASD6825F1		*ASD6825H1	
30	CHIP COLLAR	PT419R1		PT419T1		PT419FH1		PT419FH1	
31	OIL SCREW	122X103		122X103		122X103		122X103	
32	SADDLE FELT	PT59R1		PT59T1		PT59F1		PT59H1	
33	RIGHT RETAINER	PT58R1		PT58T1		PT58F1		PT58H1	
34	SCREW	107X6		107X108		107X108		107X310	
35	SCREW	122X104		122X105		122X104		122X104	
36	SADDLE SCREW	PT244R1		PT244T1		PT244F1		PT244H1	
37	COLLAR SCREW	PT210R1		PT210T1		PT210F1		PT210H1	
38	LEFT RETAINER	PT57R1		PT57T1		PT57F1		PT57H1	
39	WRENCH	CE2386		CE2387		CE2387		CE2387	
40	GIB SCREW	PT219R1		PT219TH1		PT219TH1		PT219TH1	
41	C. R. BASE (40-42-43-56-57-60)	*AS92R2		*AS92T2		*AS92F2		*AS92H2	
42	CLAMP SHOE	PT211R1		PT211T1		PT211F1		PT211H1	
43	SCREW	121X312		121X412		121X616		121X620	
44	OIL SCREW	122X103		122X504		122X504		122X504	
45	C. F. NUT SCREW (44)	*AS66R2		*AS66T2		*AS66FH2		*AS66FH2	
46	CHIP GUARD	PT96R1		PT96T1		PT96F1		PT96H1	
47	SCREW	PT1166R1		PT1167T1		PT1168FH		PT1168FH1	
48	STOP SCREW	PT245NR1		PT245TH1		PT245TH1		PT245TH1	
49	CAP SCREW	PT2903R1		PT2904TF1		PT2904TF1		PT2905H1	
50	THREAD STOP (48-49)	*CL2250R		*CL2250T		*CL2250F		*CL2250H	
51	SADDLE	WRITE FOR INFORMATION							
52	SADDLE LOCK	PT62R2		PT62T2		PT62F2		PT62H2	
53	SADDLE GIB SCREW	112X116		112X120		112X224		112X224	
54	WASHER	182X301		182X301		180X302		180X302	
55	SADDLE GIB	PT61R1		PT61T1		PT61F1		PT61H1	
56	SHOE	PT1082NT1		PT1077TH1		PT1077TH1		PT1077TH1	
57	SCREW	122X203		122X505		122X503		122X508	
58	C. F. NUT-ENGLISH	PT65R1		PT65T1		PT65FH1		PT65FH1	
59	C. F. NUT-METRIC	PT2231R1		PT2231T1		PT2231FH1		PT2231FH1	
60	C. R. BASE GIB	PT221R1		PT221T1		PT221F1		PT221H1	
61	WRENCH	CE2387		CE2388		CE2388		CE2388	
62	BEARING	AS841R1		AS841R1		AS841R1		AS841T2	
63	BEARING COVER	PT899R1							
64	REAR T. A. SCREW (14-15.*45-58)	*AS6827L2		*AS6827T2		*AS6827F2		*AS6827H2	
65	OILER	155x14		155x15		155x15		155x15	
66	CROSS FEED SCREW (2-3.*4.*8-17-18-19-20-21-30.*45-58)							*AS224V1	
67	CROSS FEED SCREW (2-3.*4.*9-17-18-19-20-21-30.*45-58)							*ASD224V1	